

TP 4

CATIA V5

SURFACE

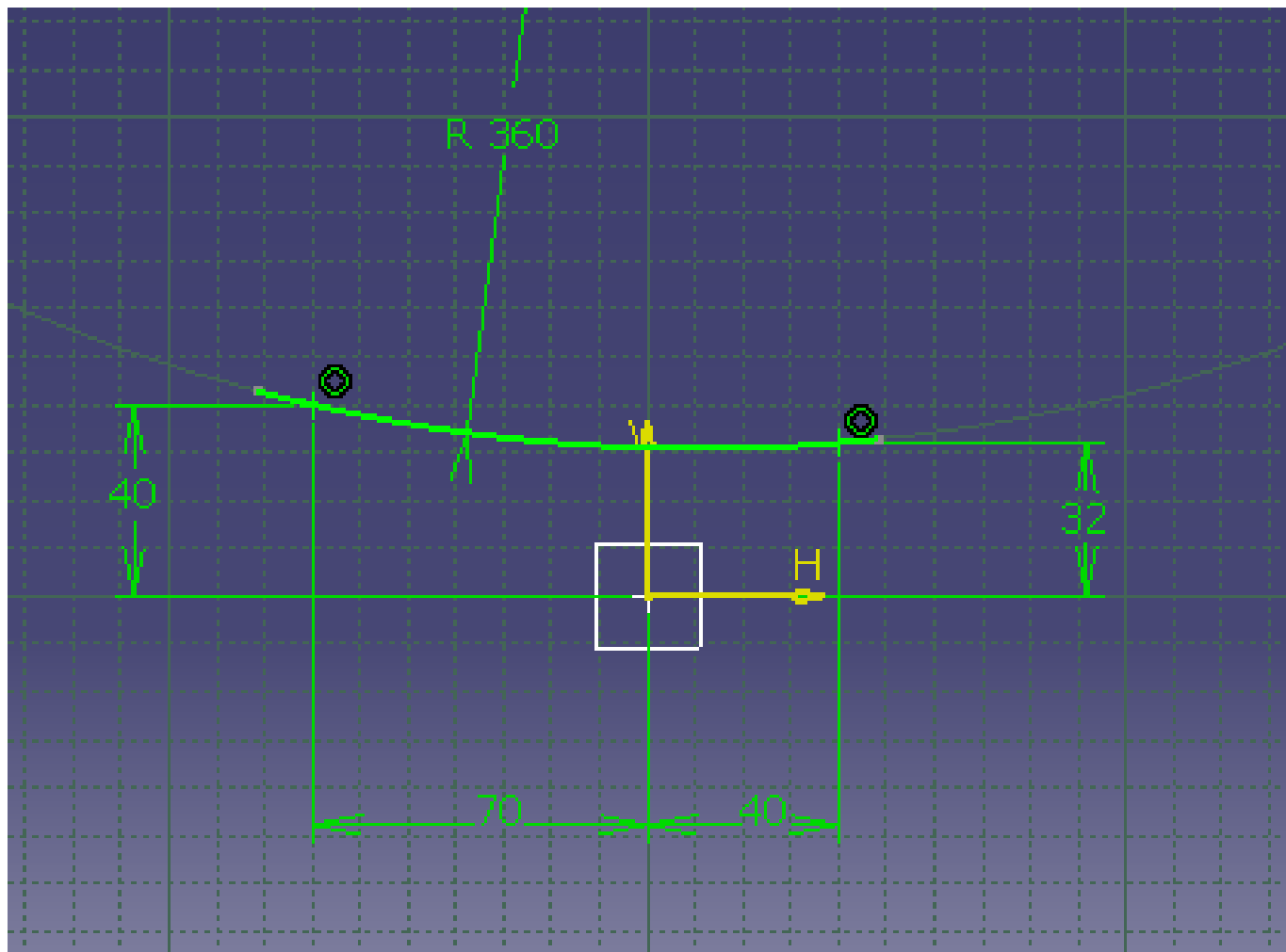

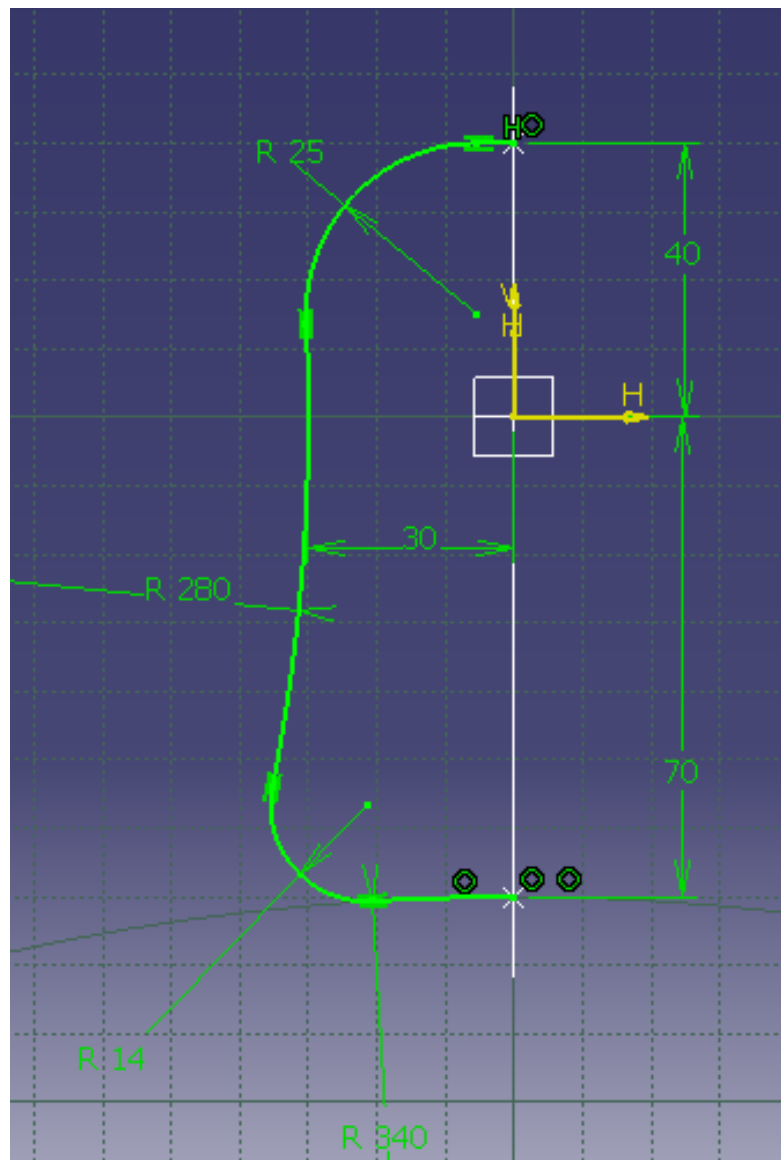

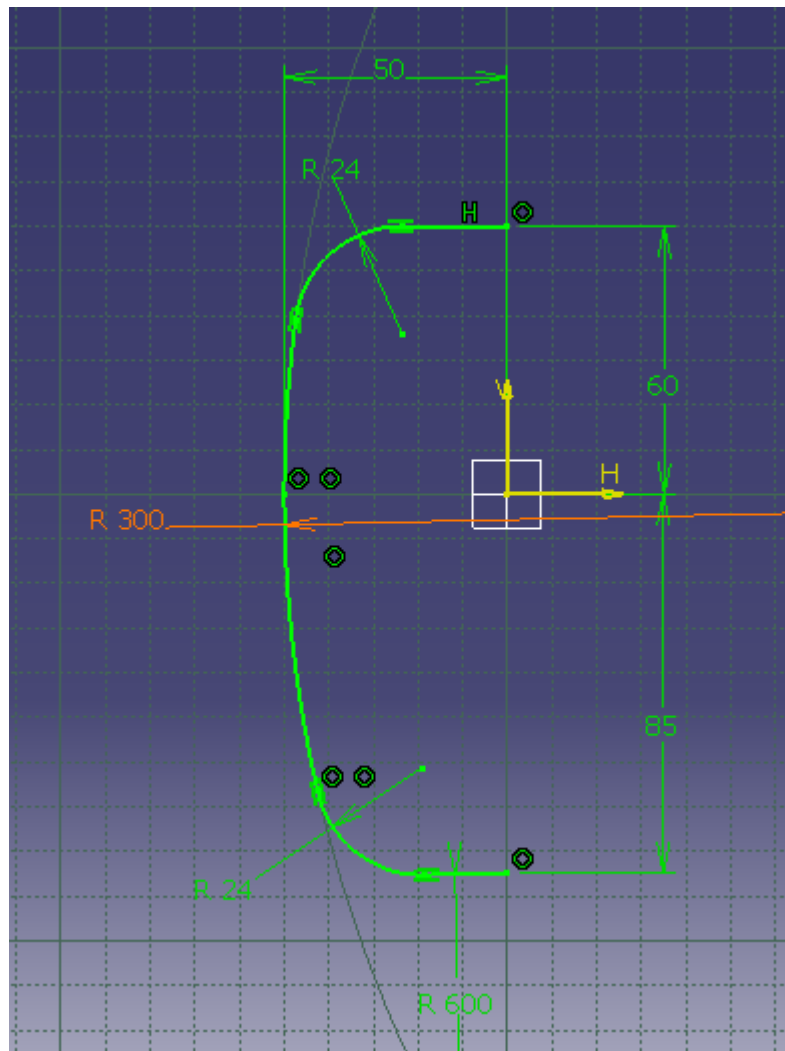

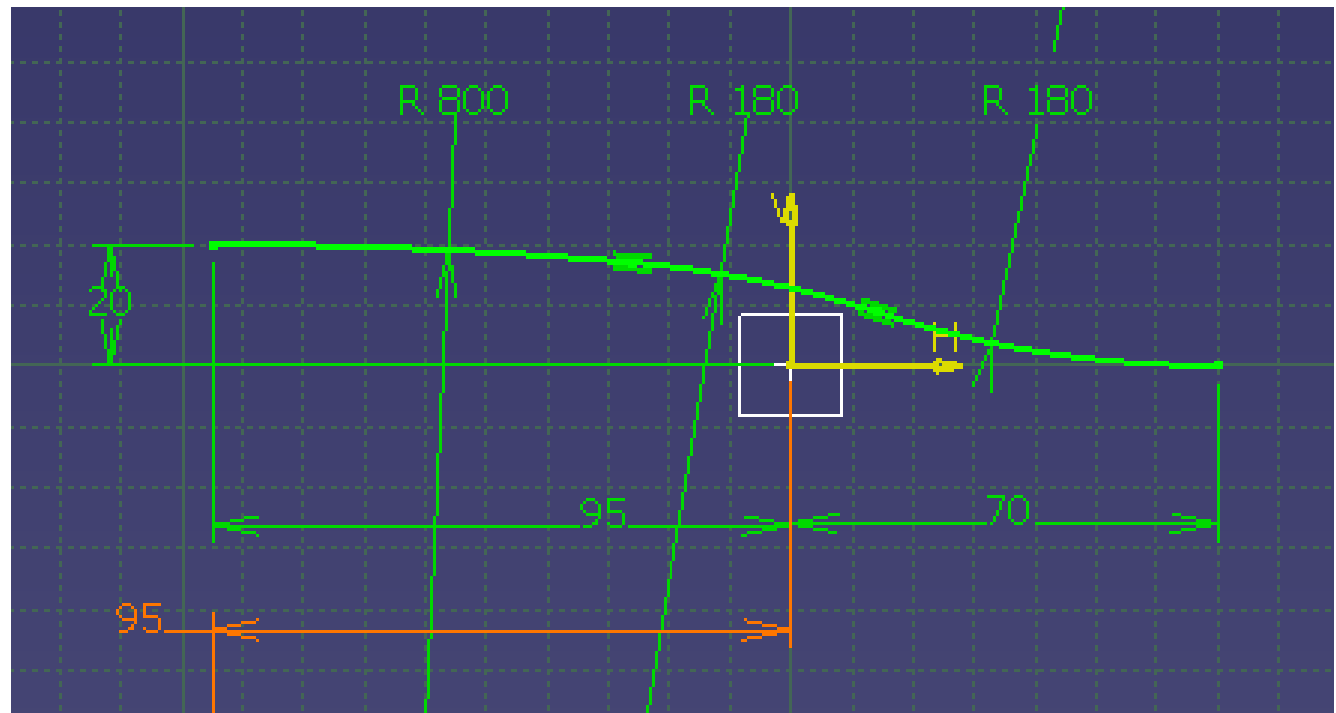

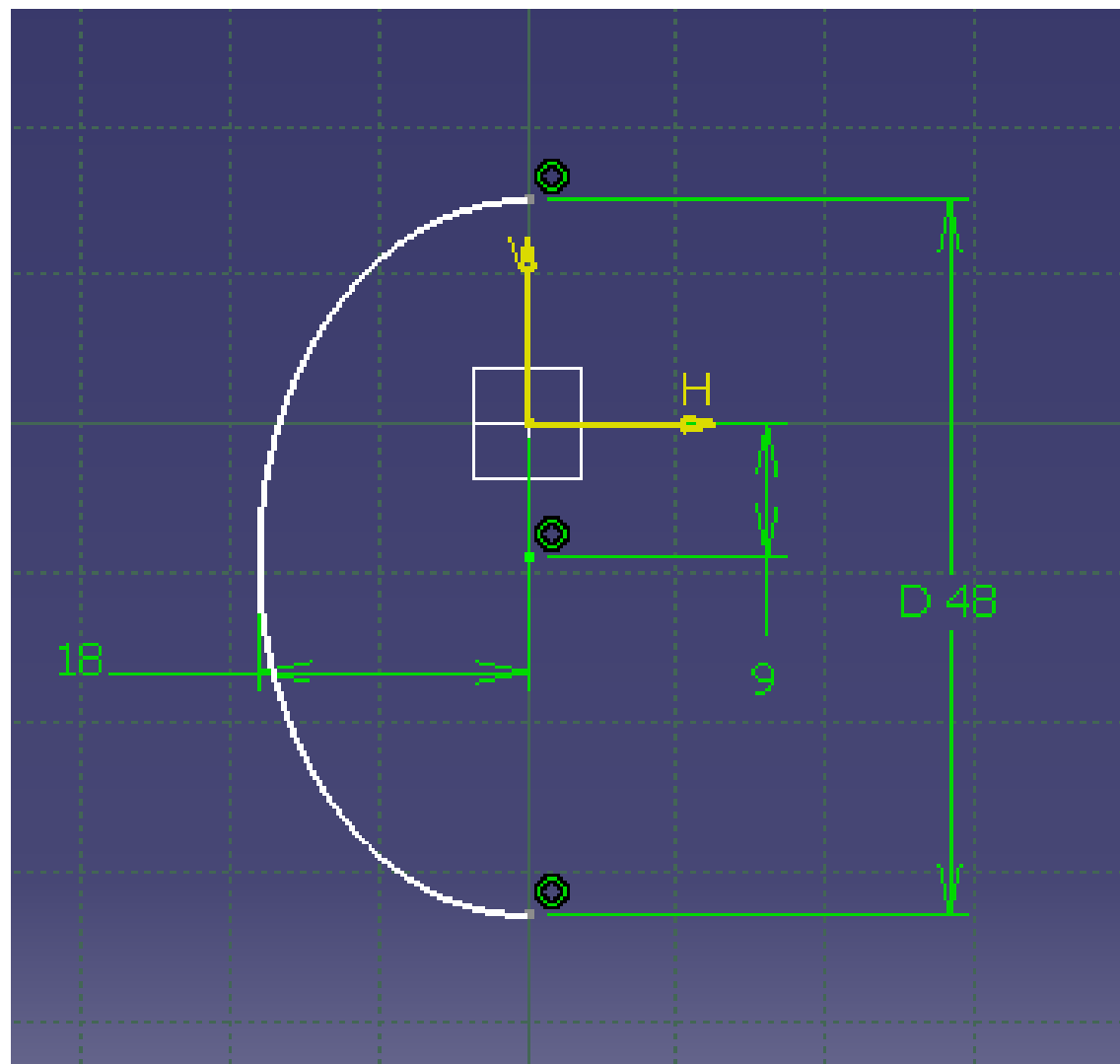

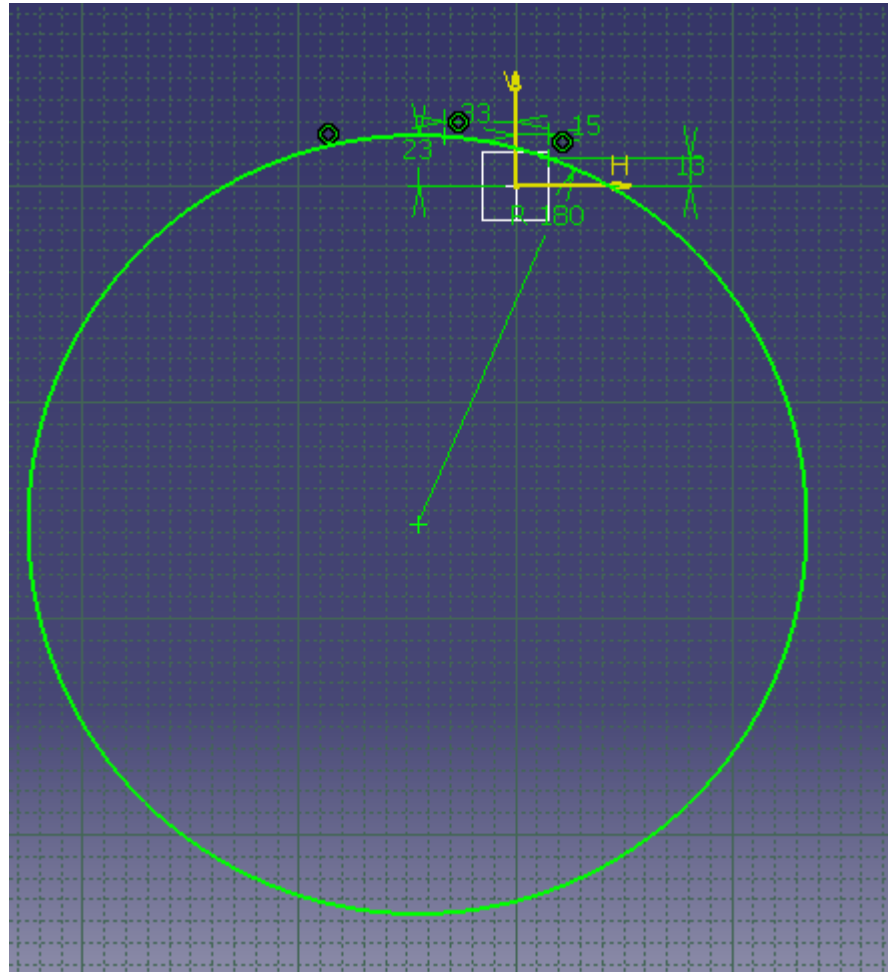

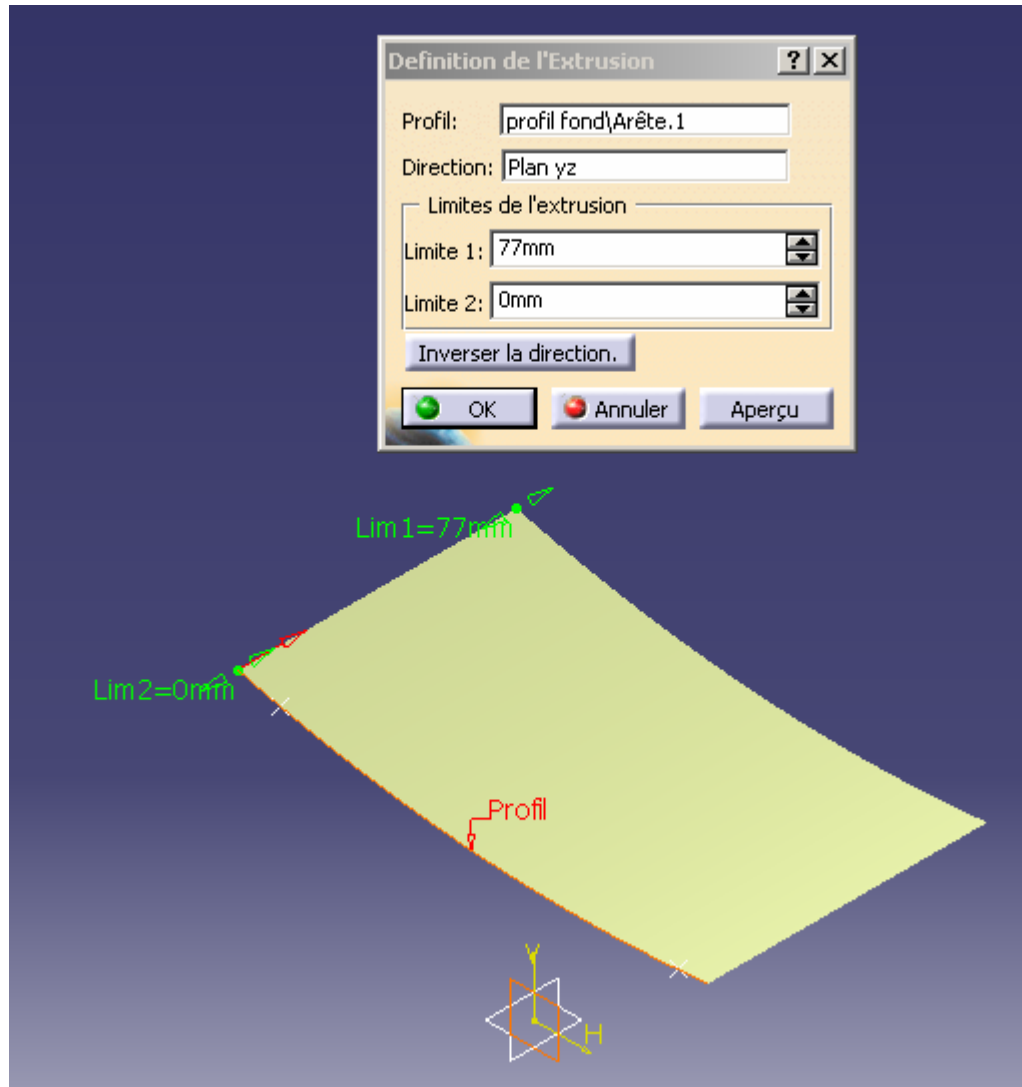

Extrusion.1 Surface fond

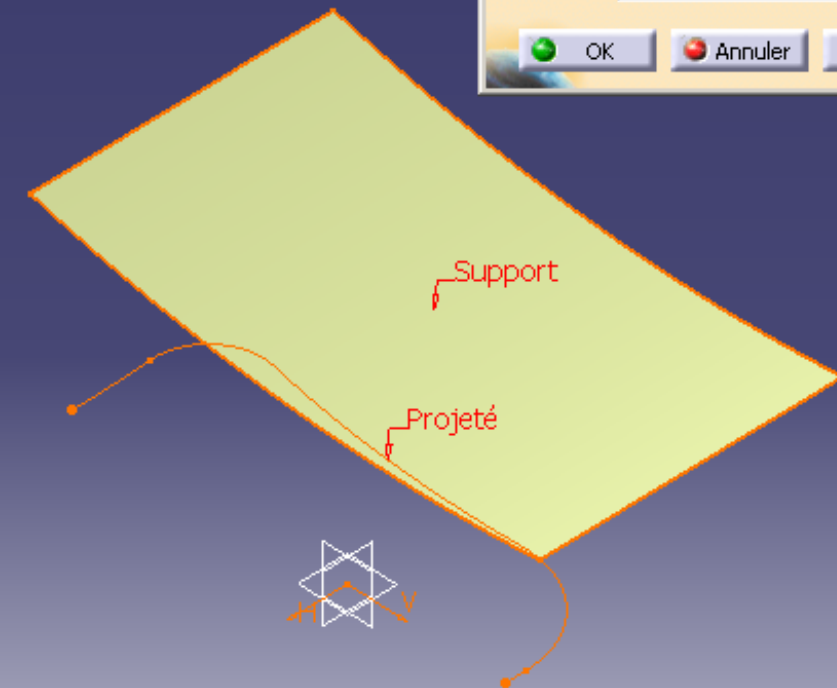
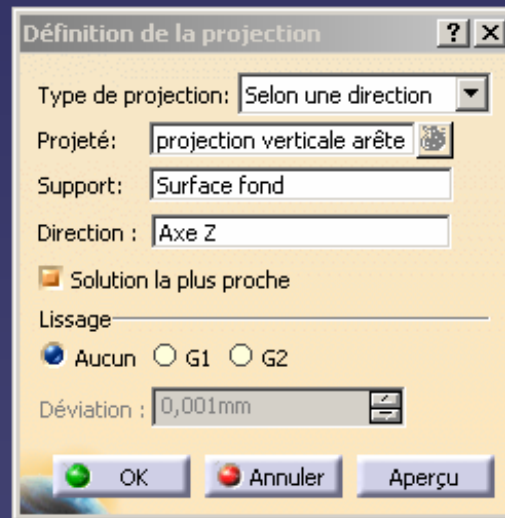

Renommer Projection.1

Arête fond

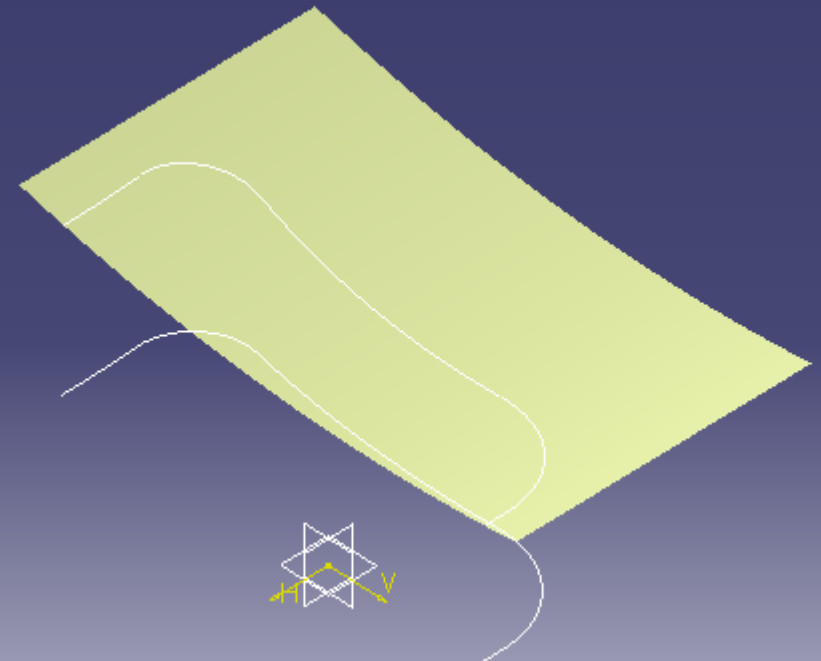

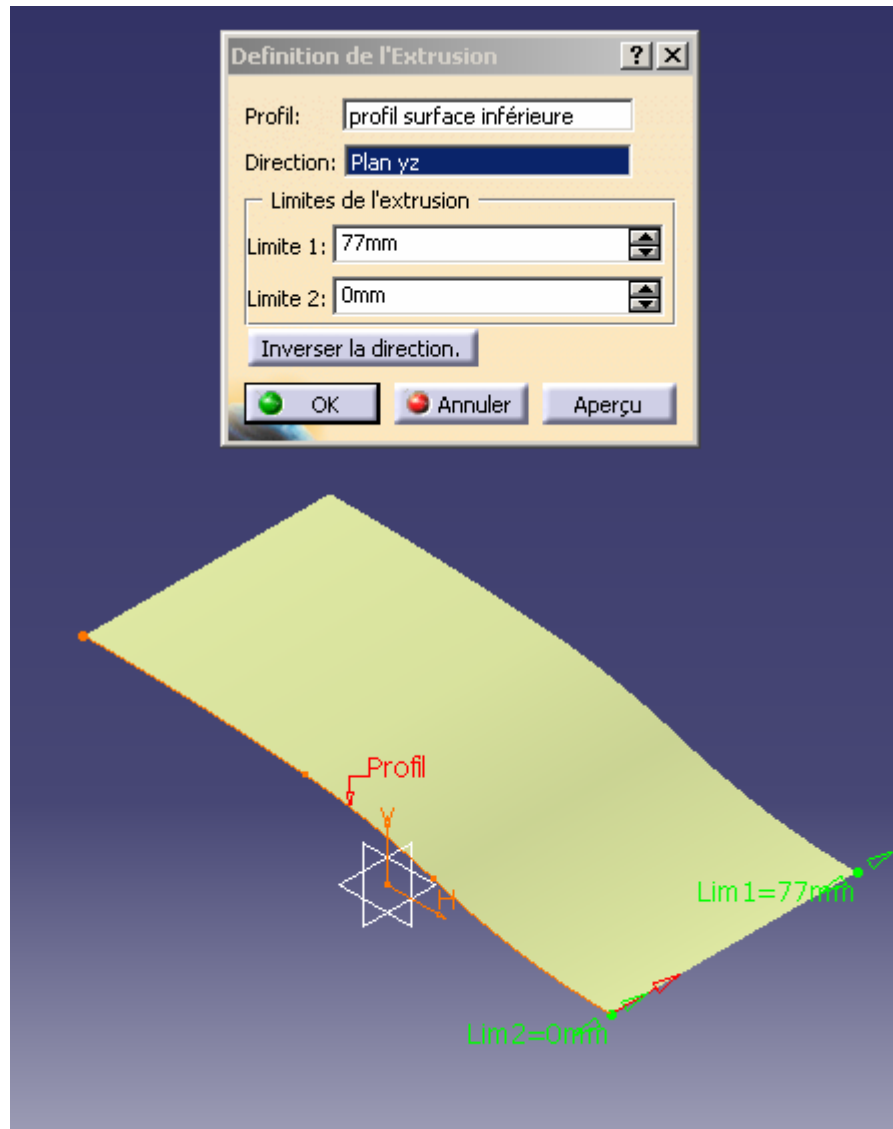

Renommer Extrusion.2

surface fond

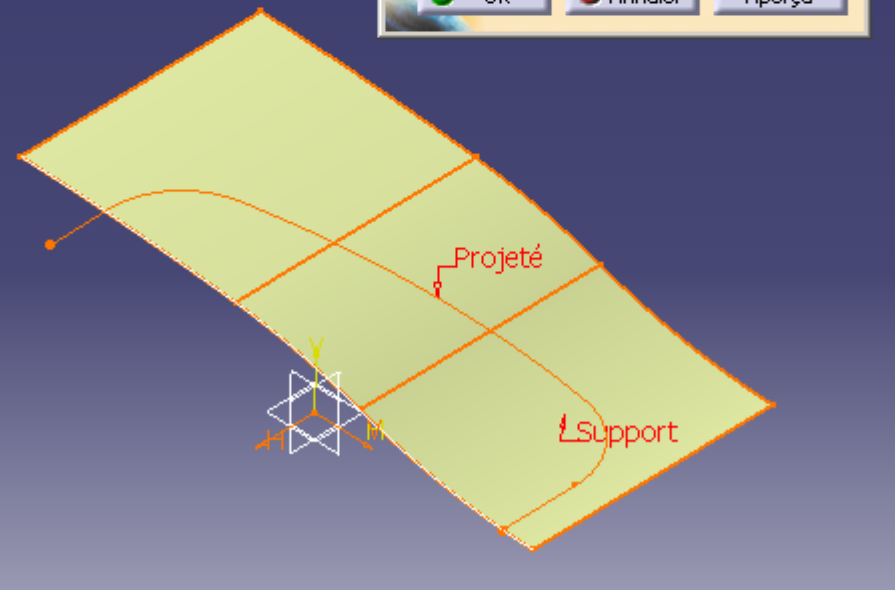
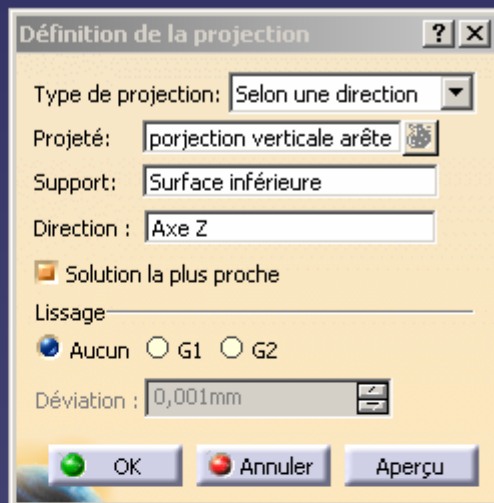

Renommer Projection.2

Arête inférieure

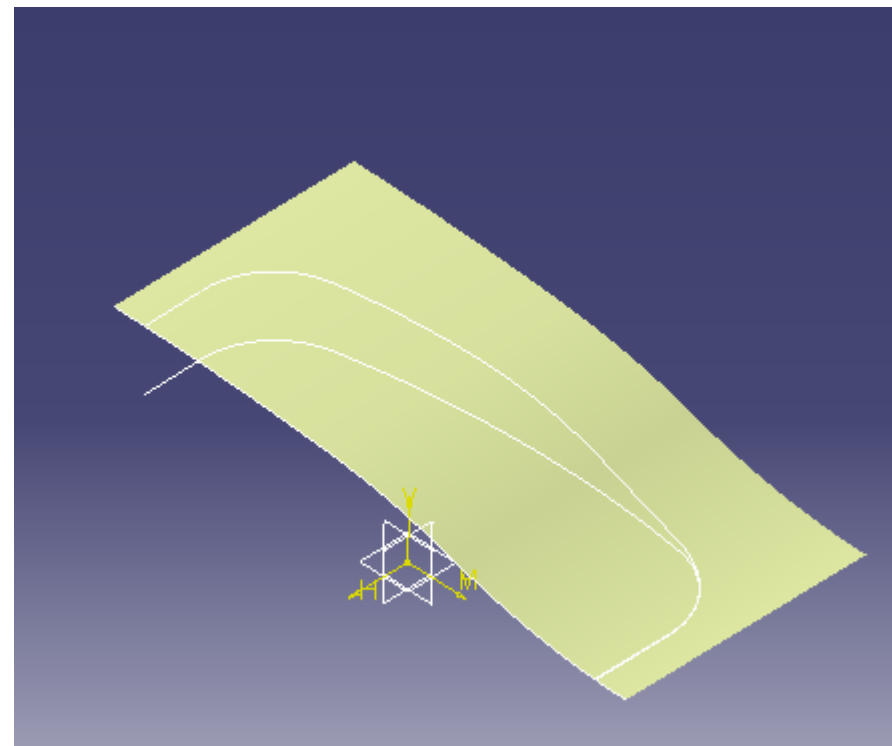

Définition du Point ? X

Type de point : Sur courbe ▾

Courbe: Profil fond

Distance à la référence

☐ Distance sur la courbe

☒ Fraction de longueur de courbe

Valeur: 0

☒ Géodésique ☐ Euclidien

Extrémité la plus proche Point milieu

Référence

Point: Défaut (Extrémité)

Inverser la direction

☐ Répéter l'objet après OK

OK Annuler Aperçu

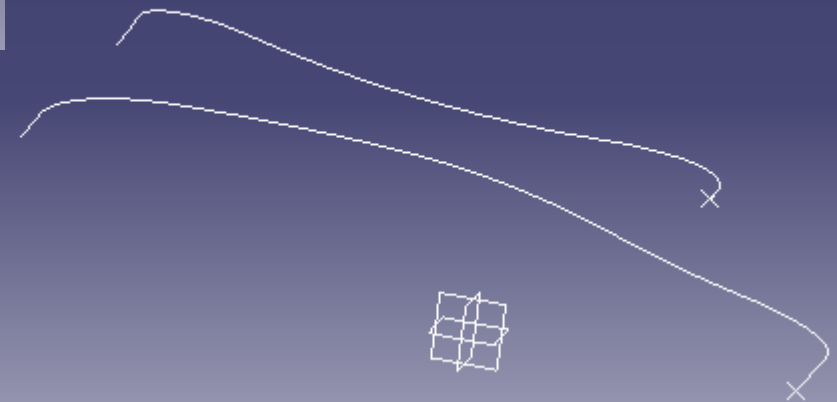
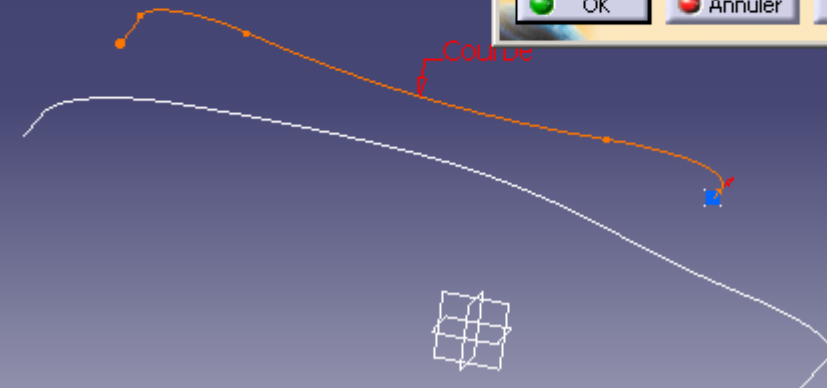
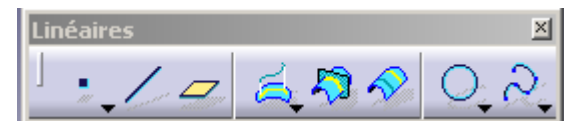

Définition du cercle [?] [X]

Type de cercle : 2 Points - Rayon ▾

Point 1: Point.2

Point 2: Point.4

Support: Plan yz

Rayon: 100mm

☒ Géométrie sur support

Solution suivante

Relimitations du cercle

Début: 0deg

Fin: 180deg

OK Annuler Aperçu

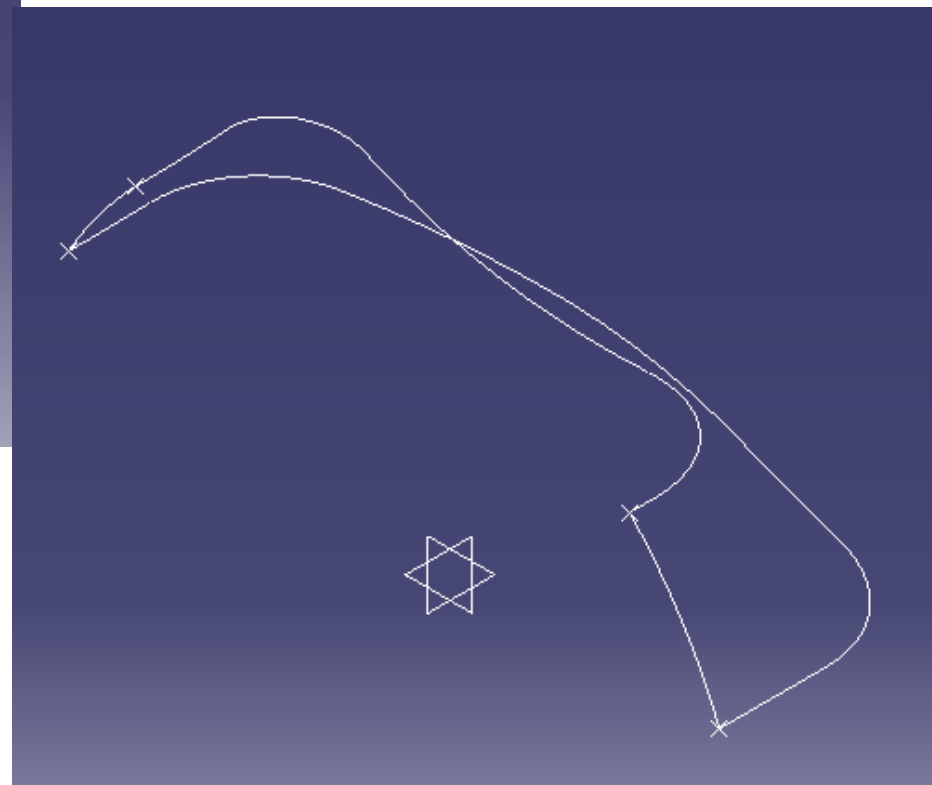
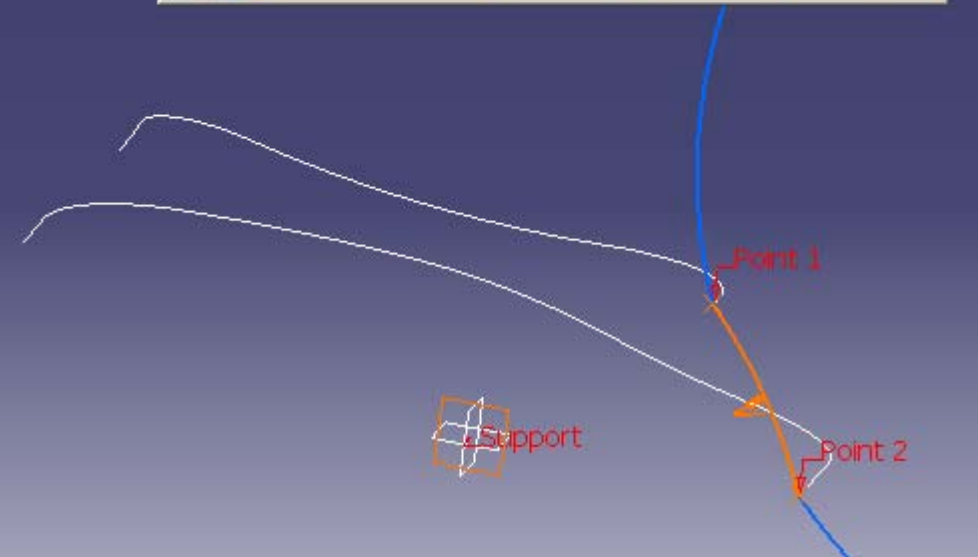
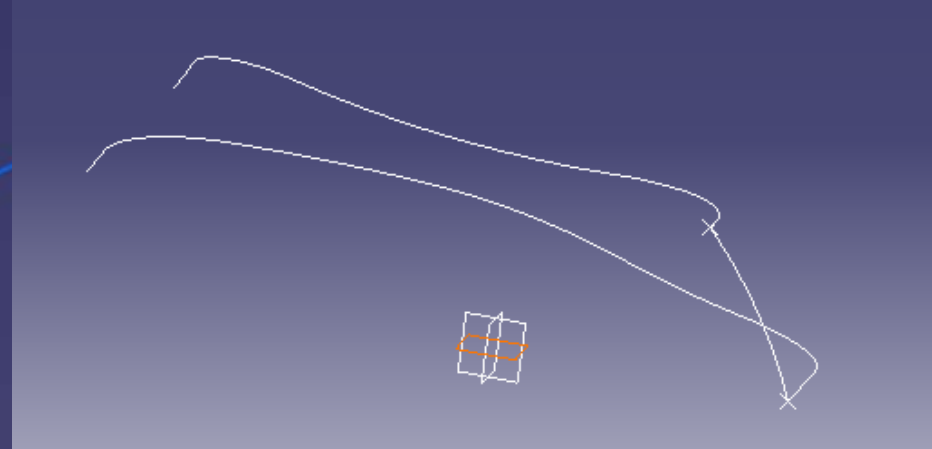

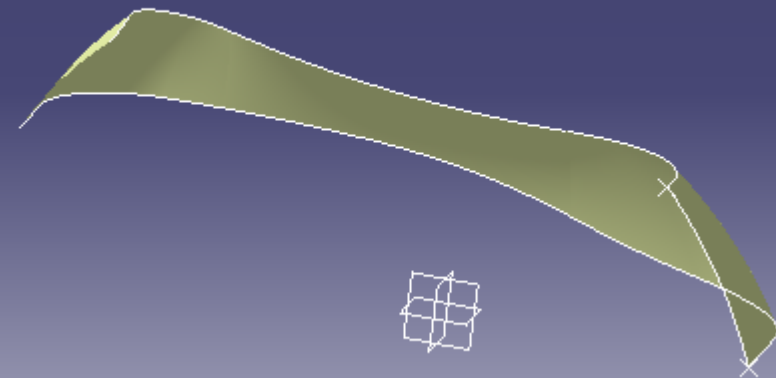
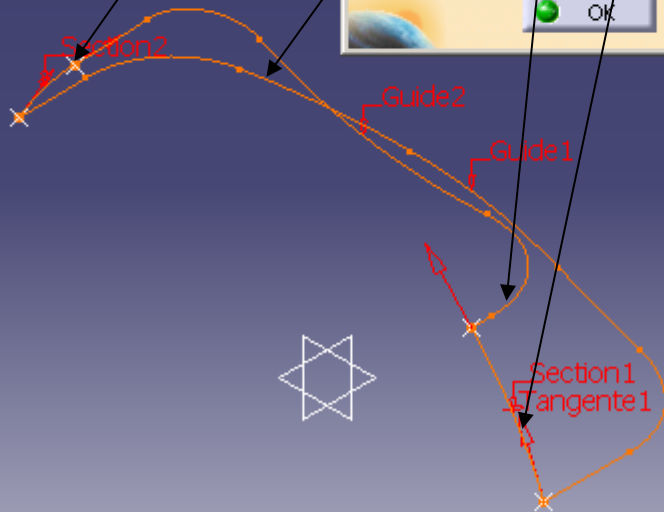
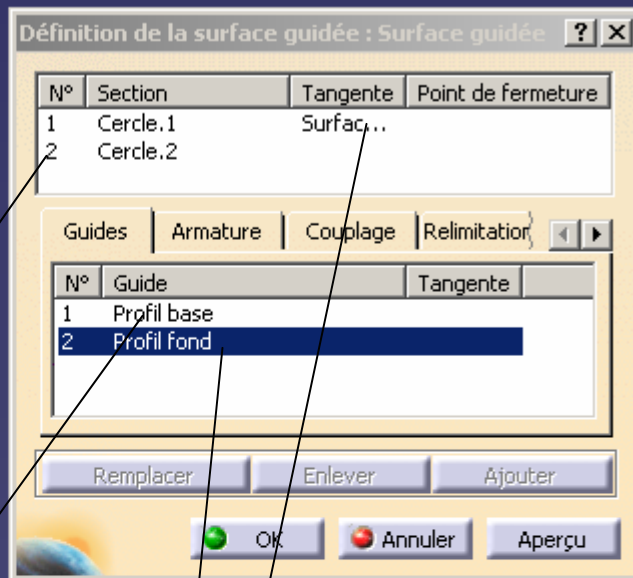

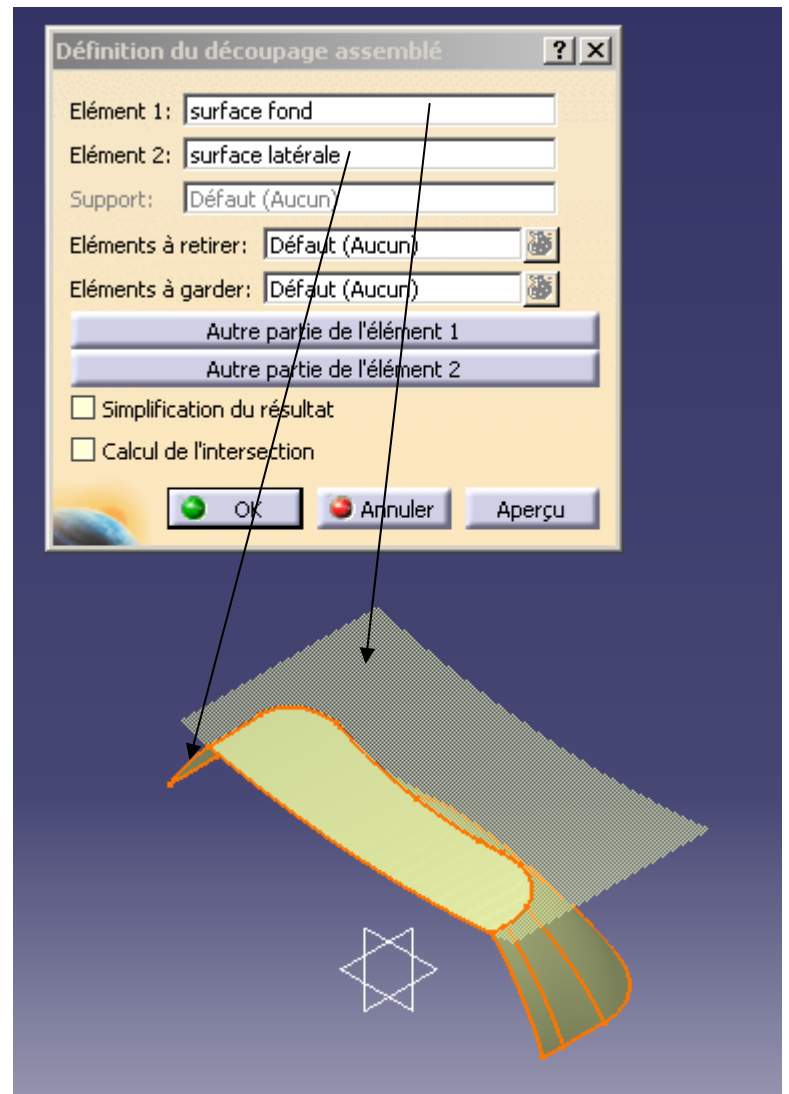
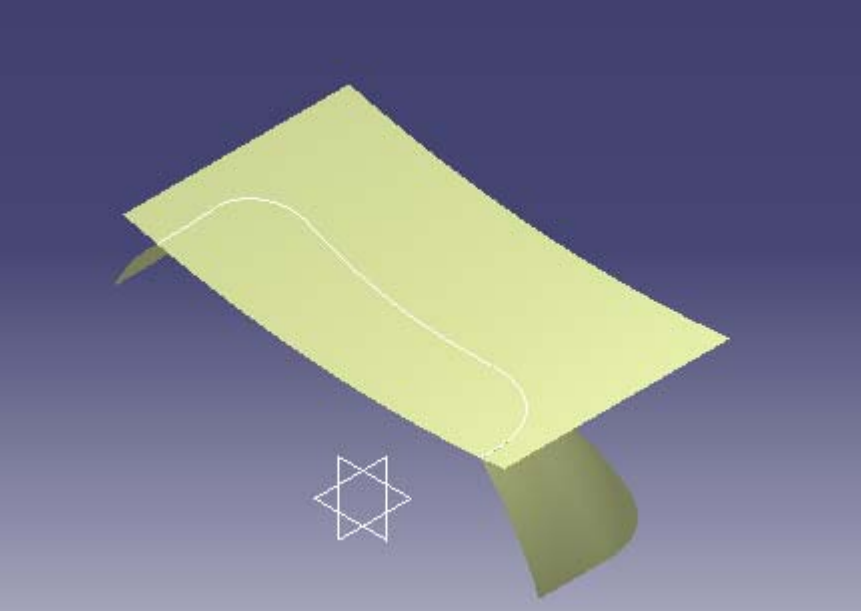

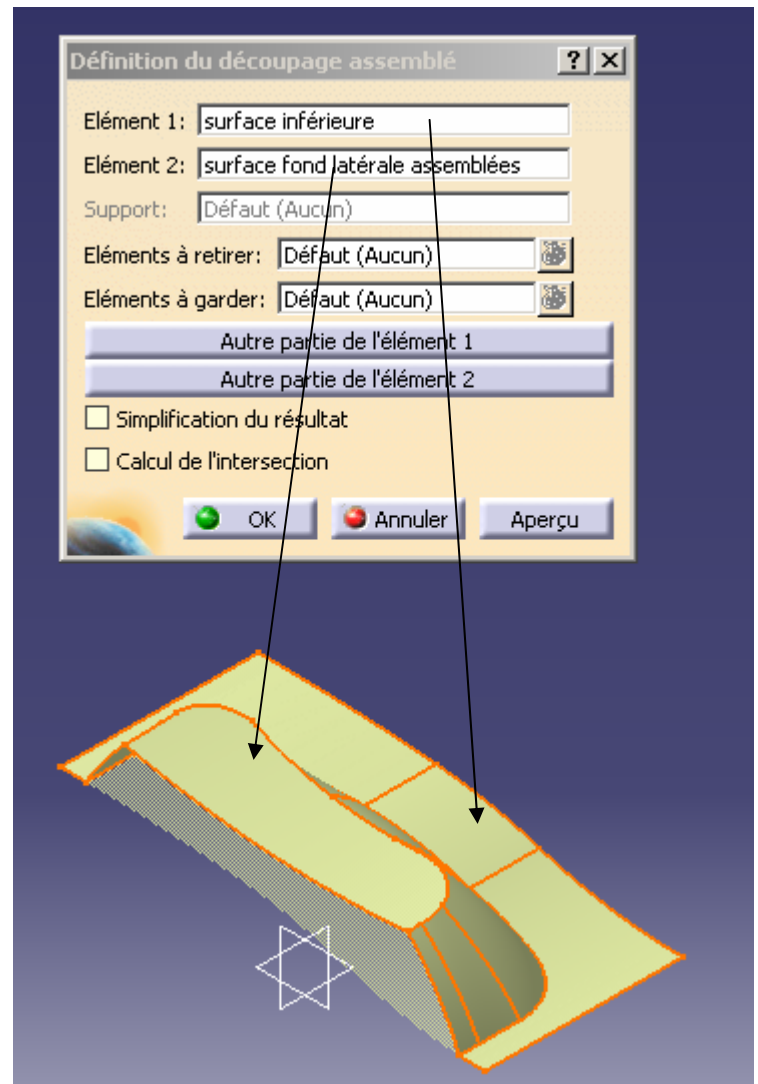
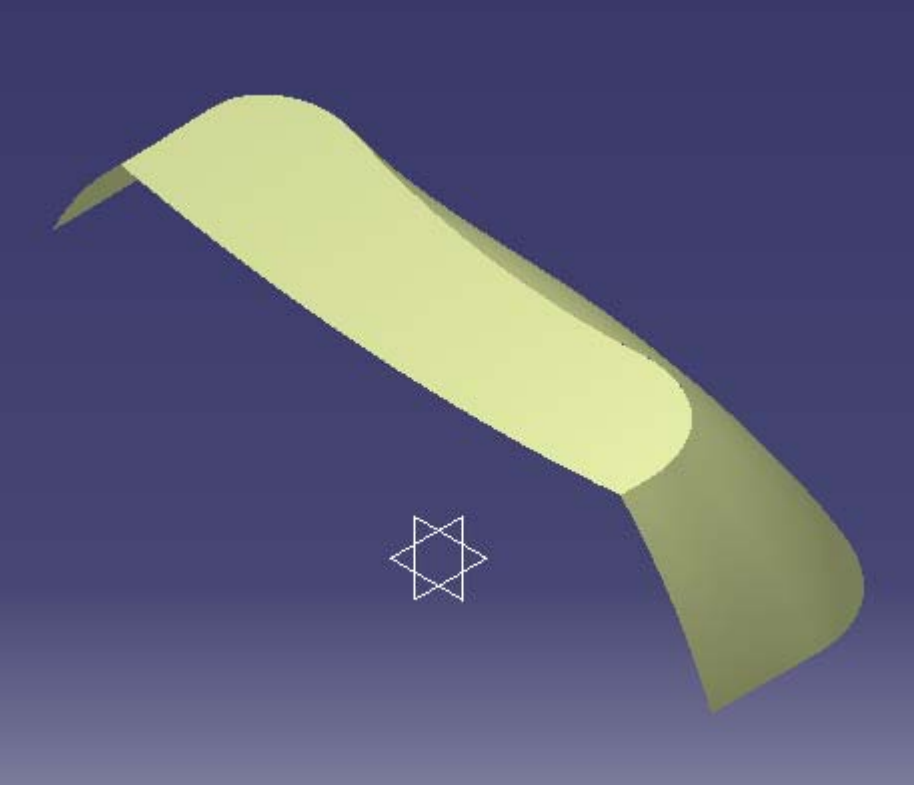

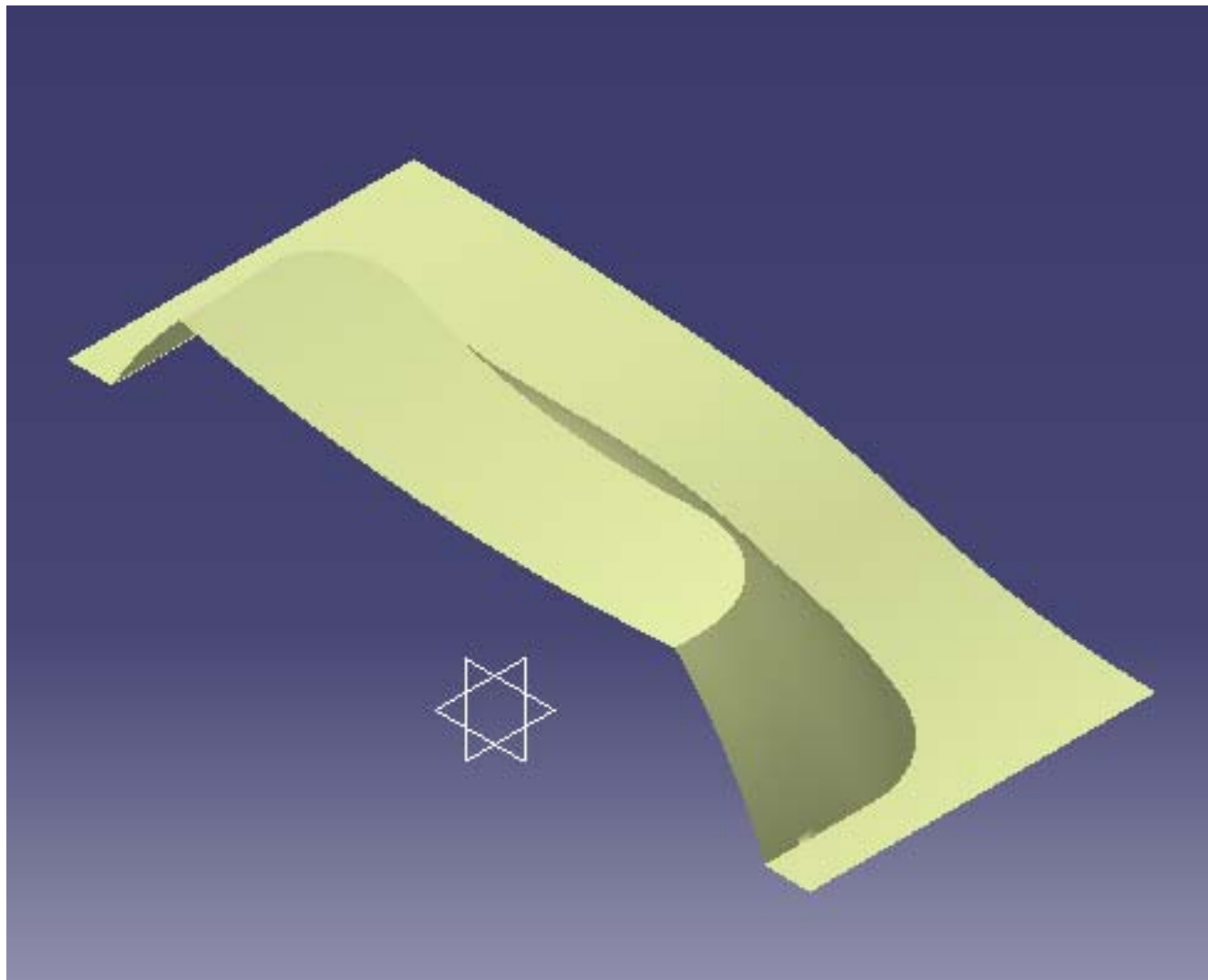

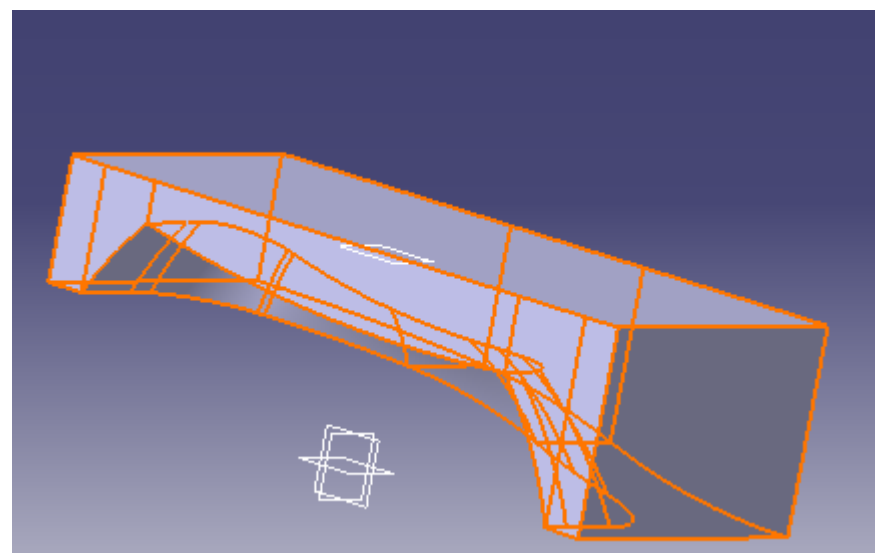
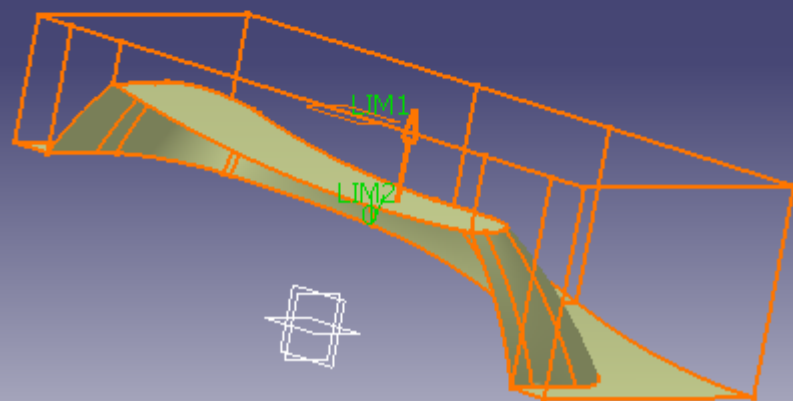
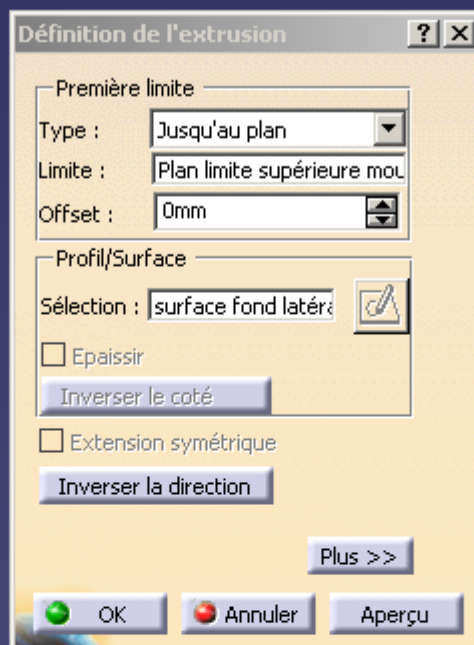

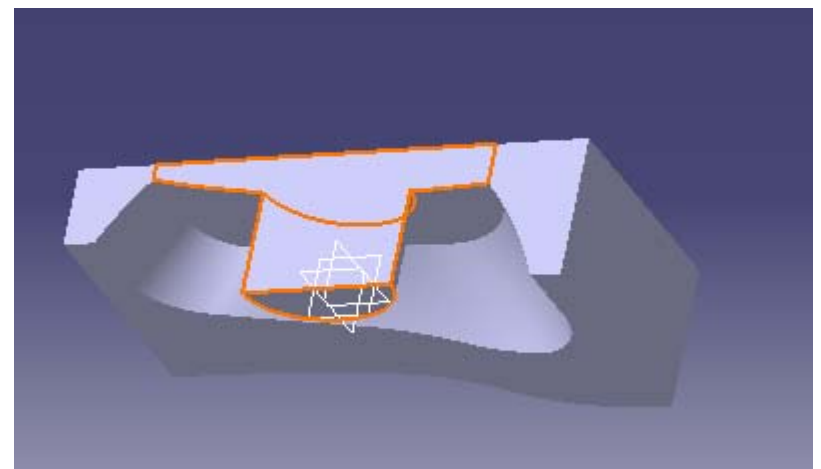
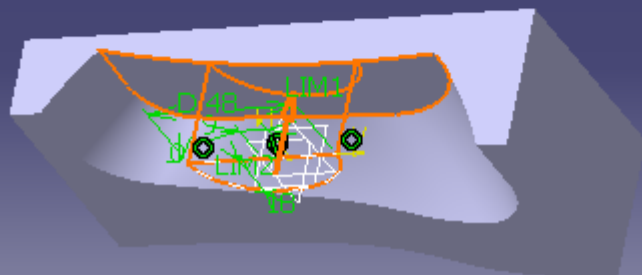
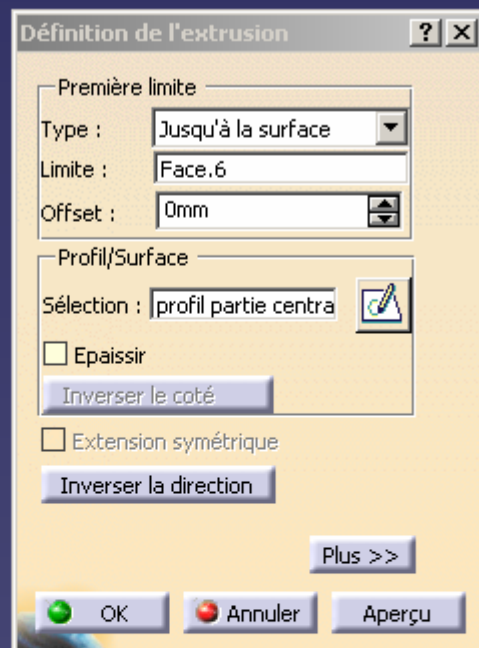

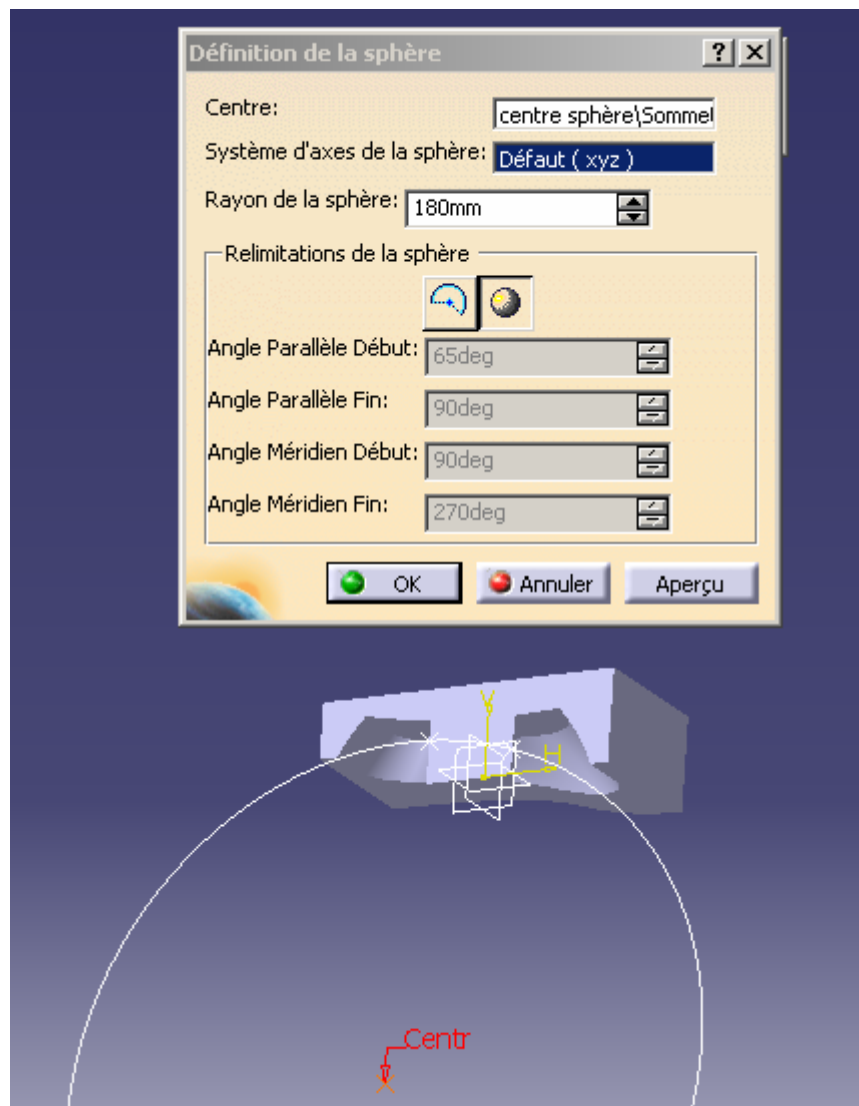
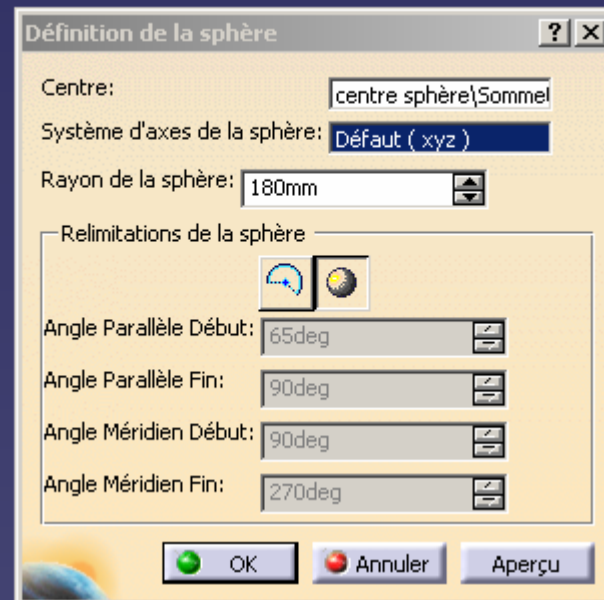
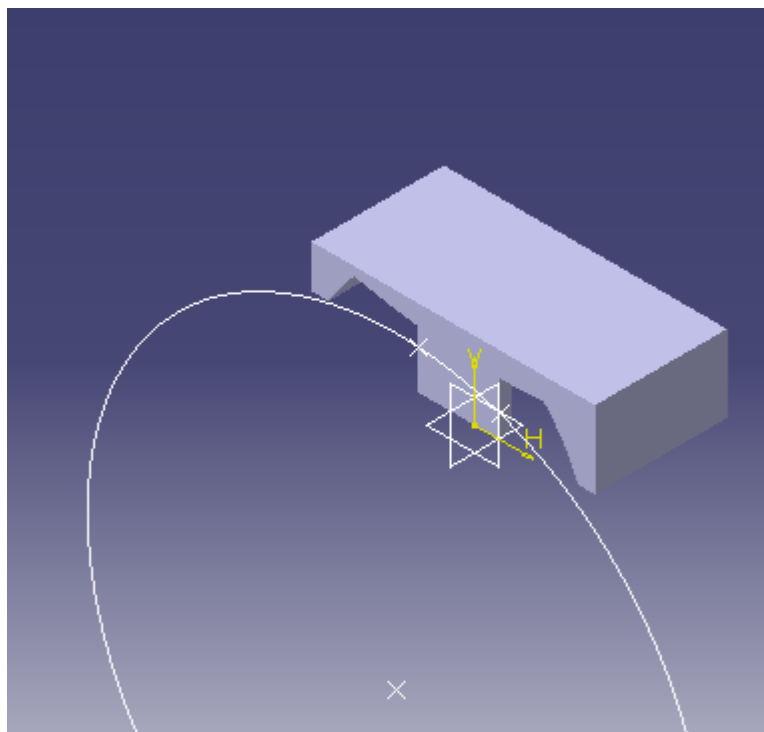

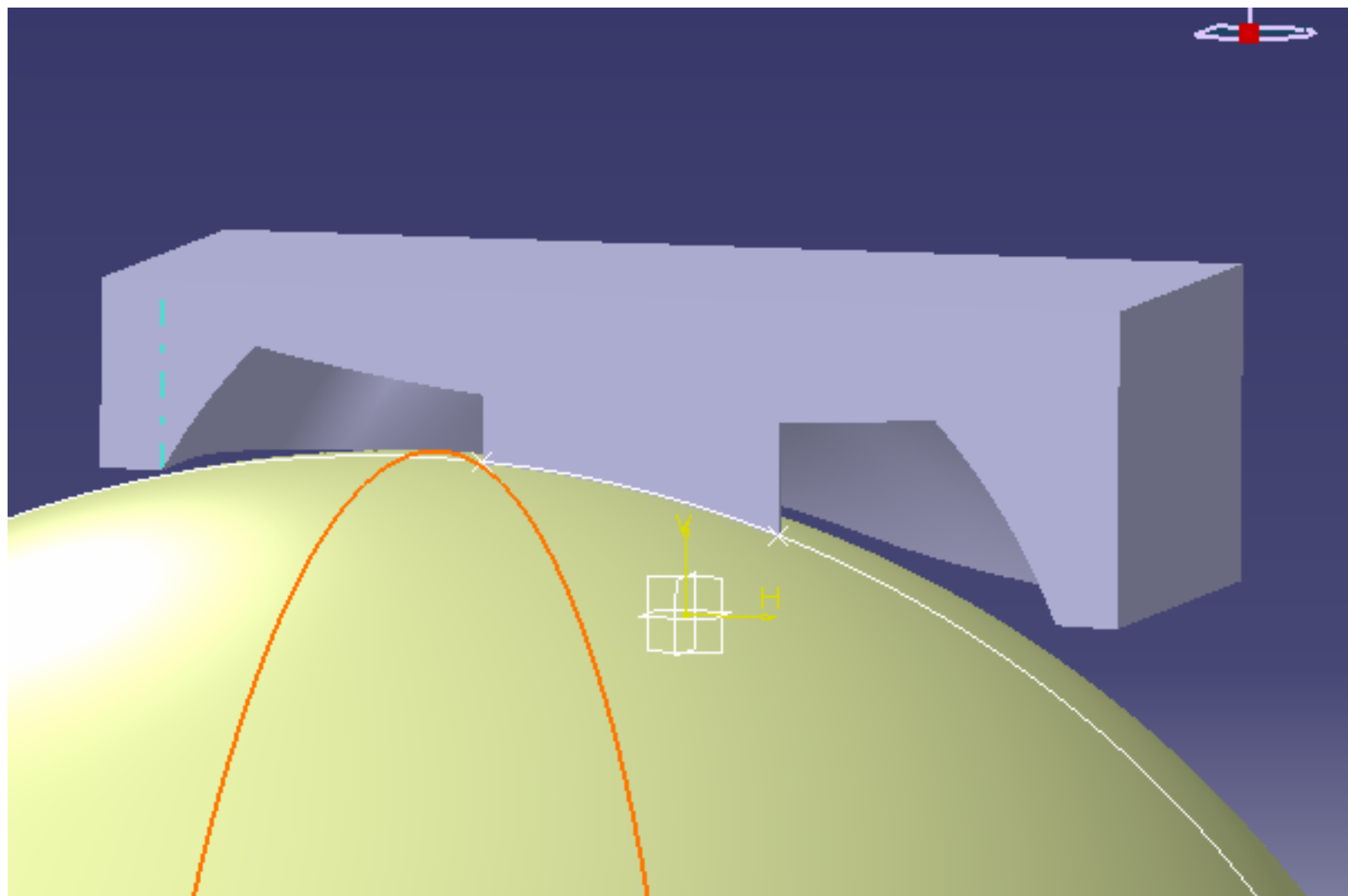

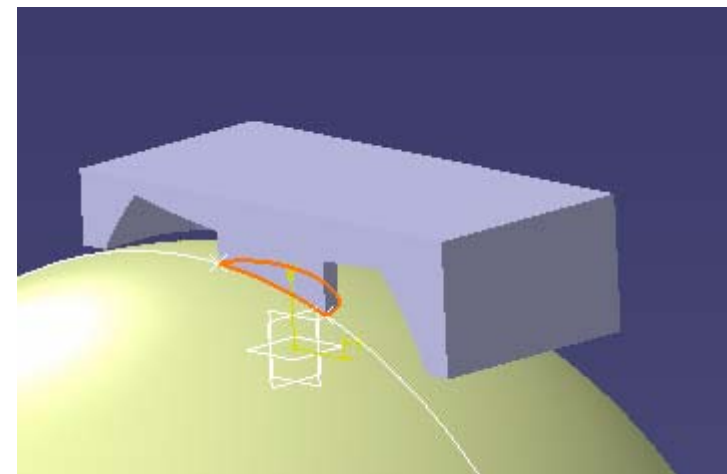
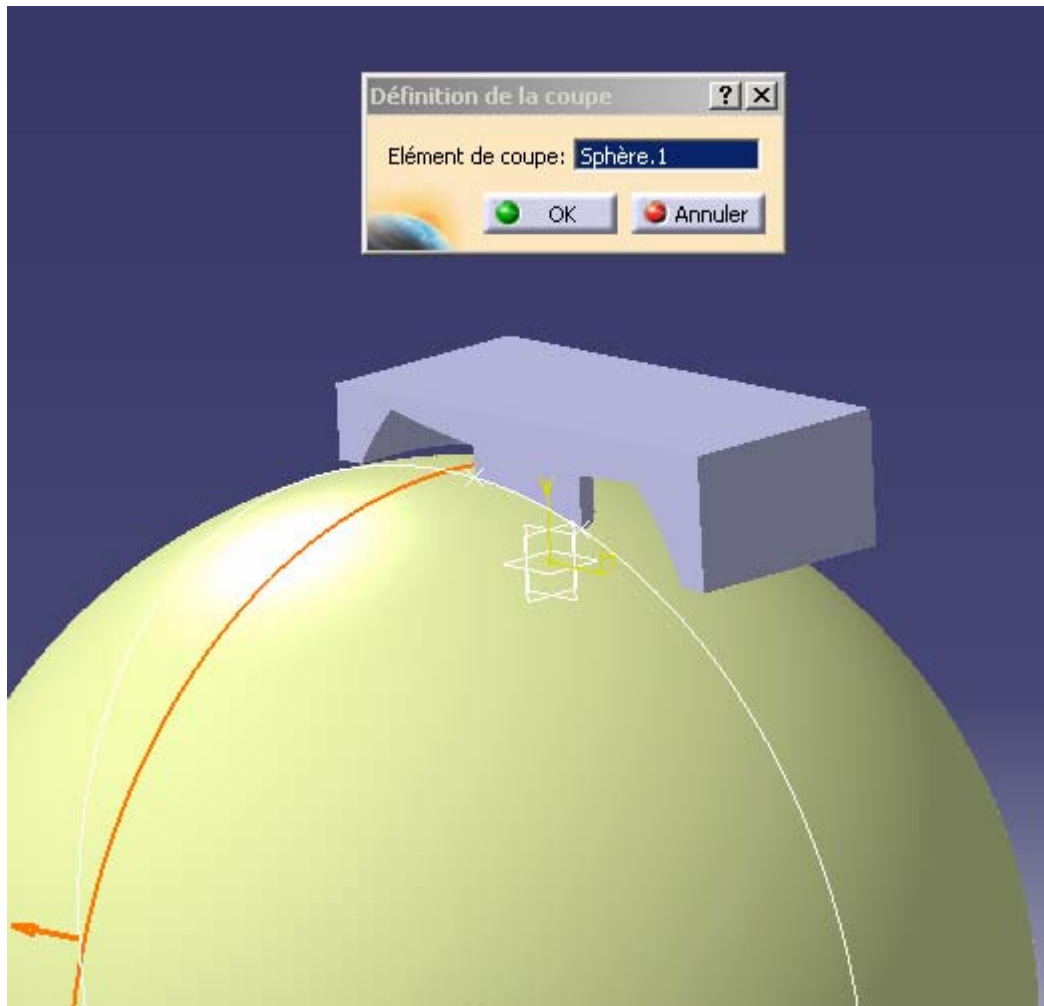

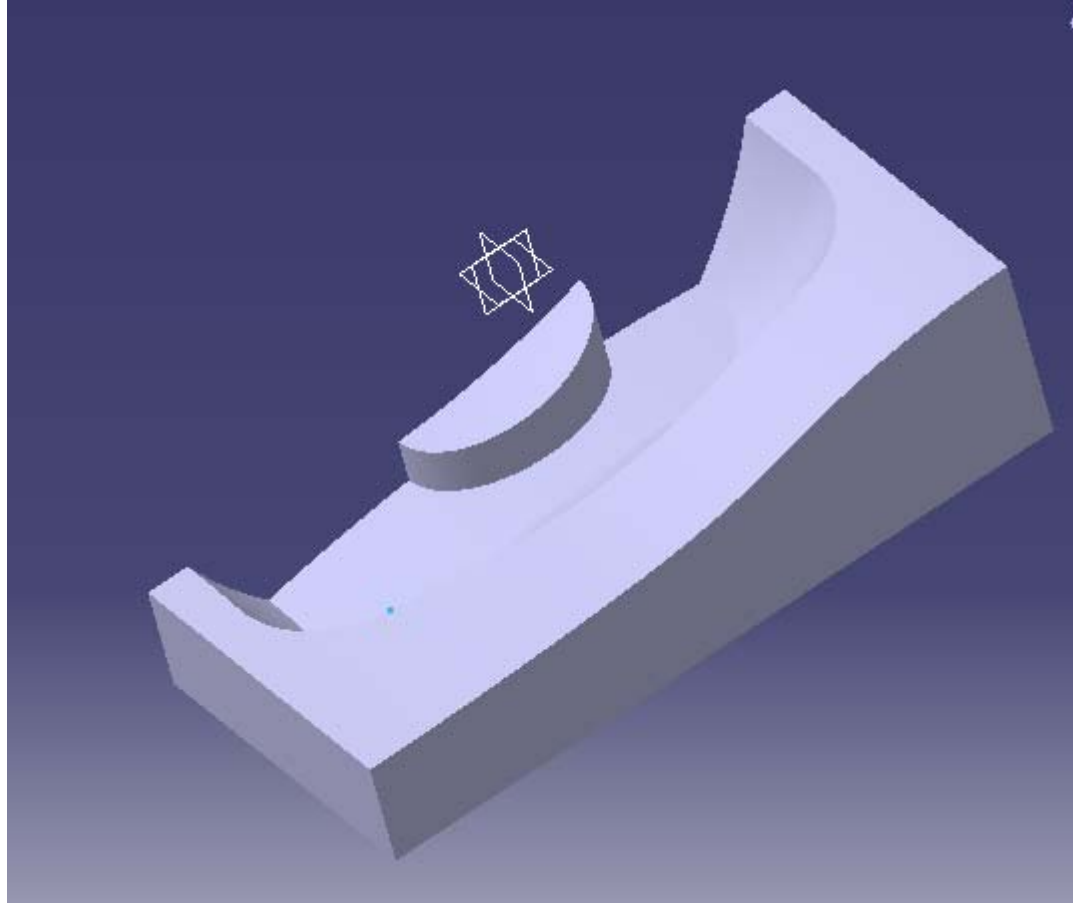

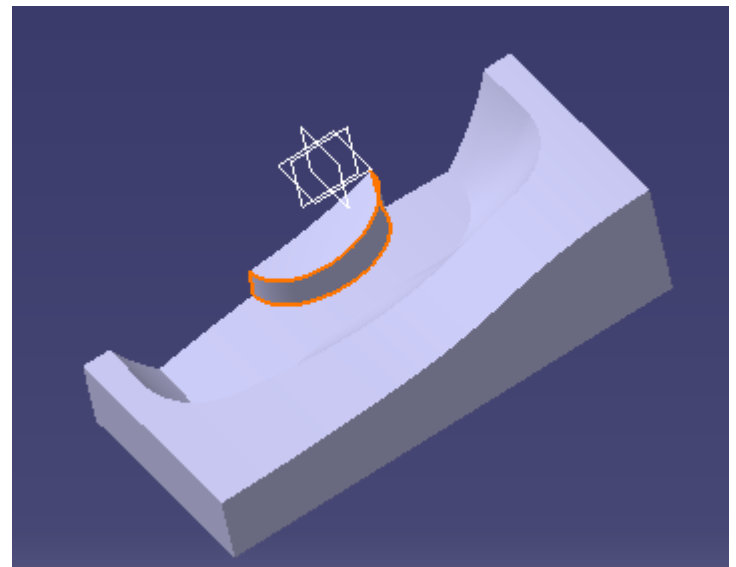
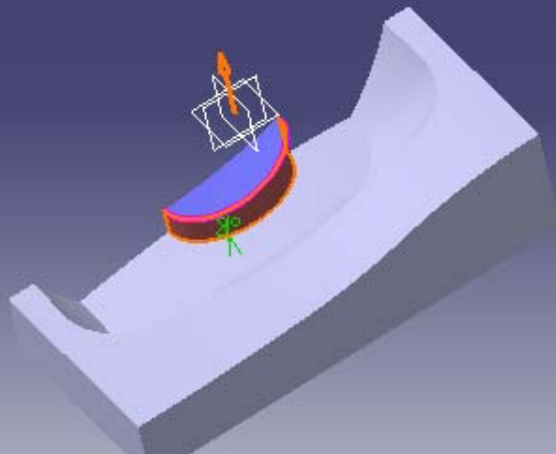
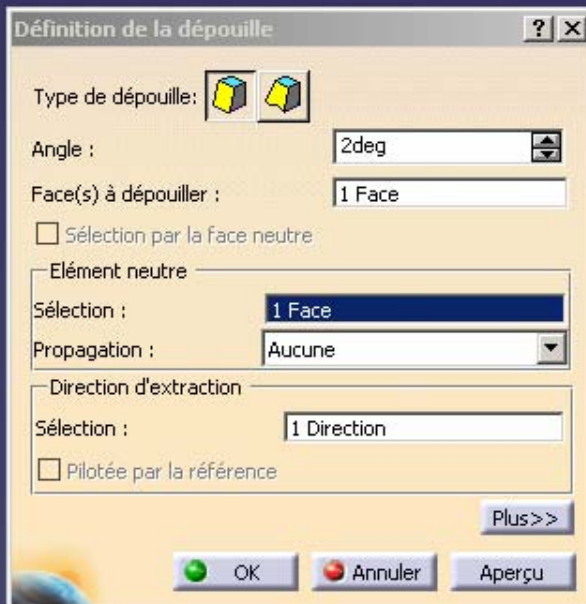

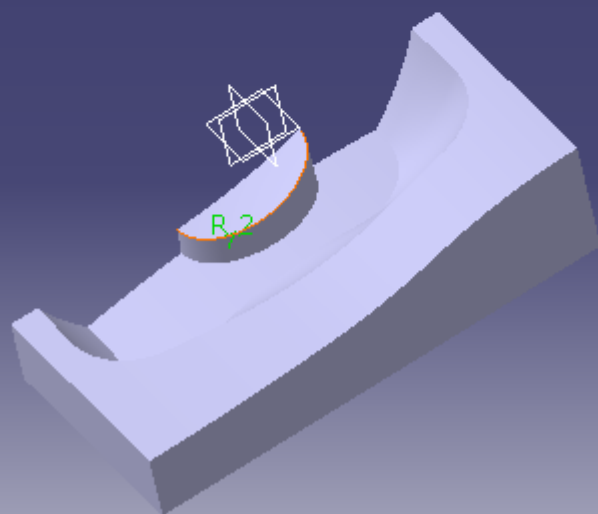
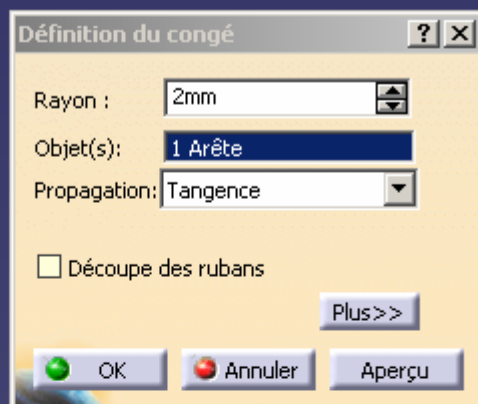

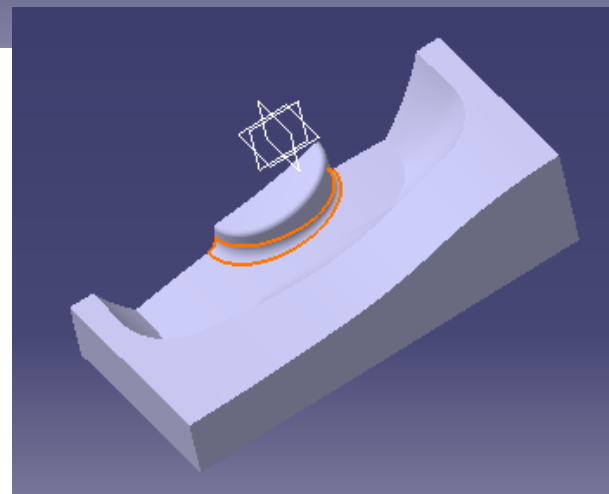
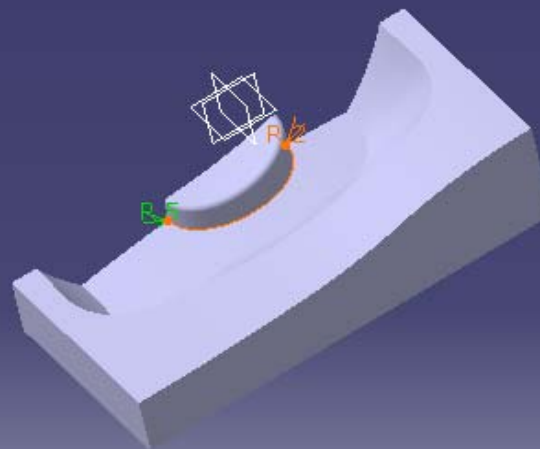
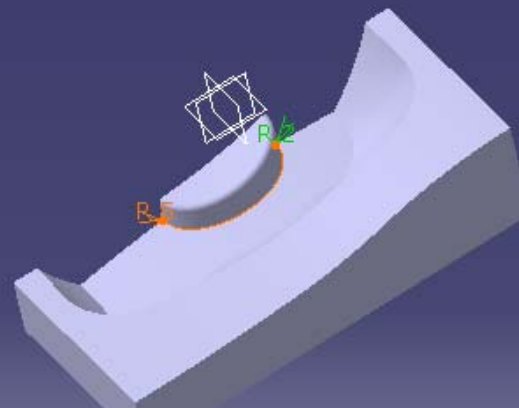
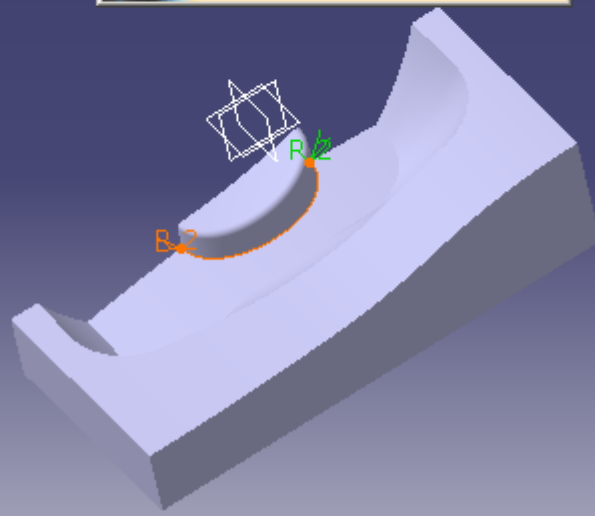
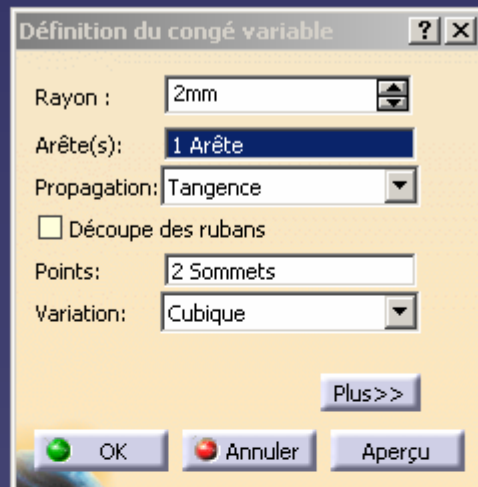

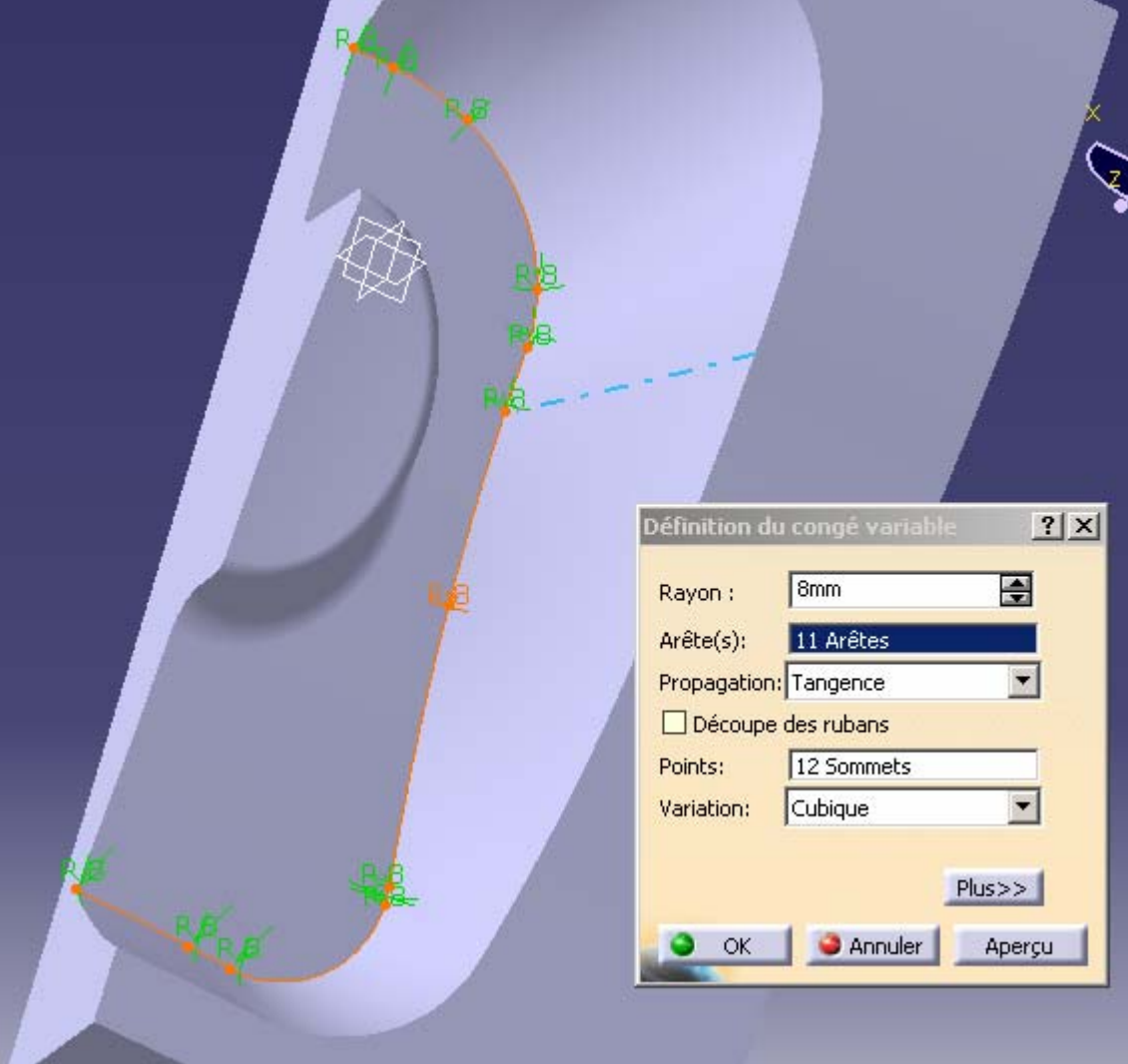

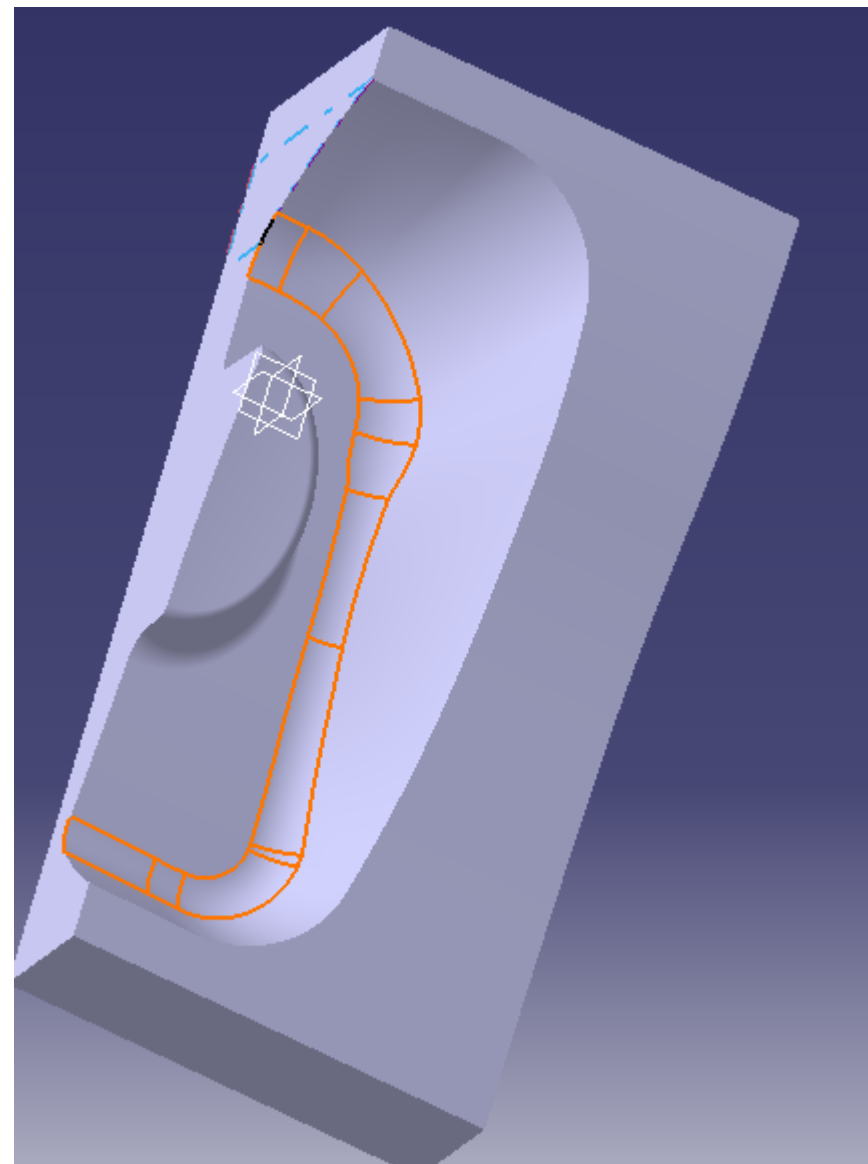

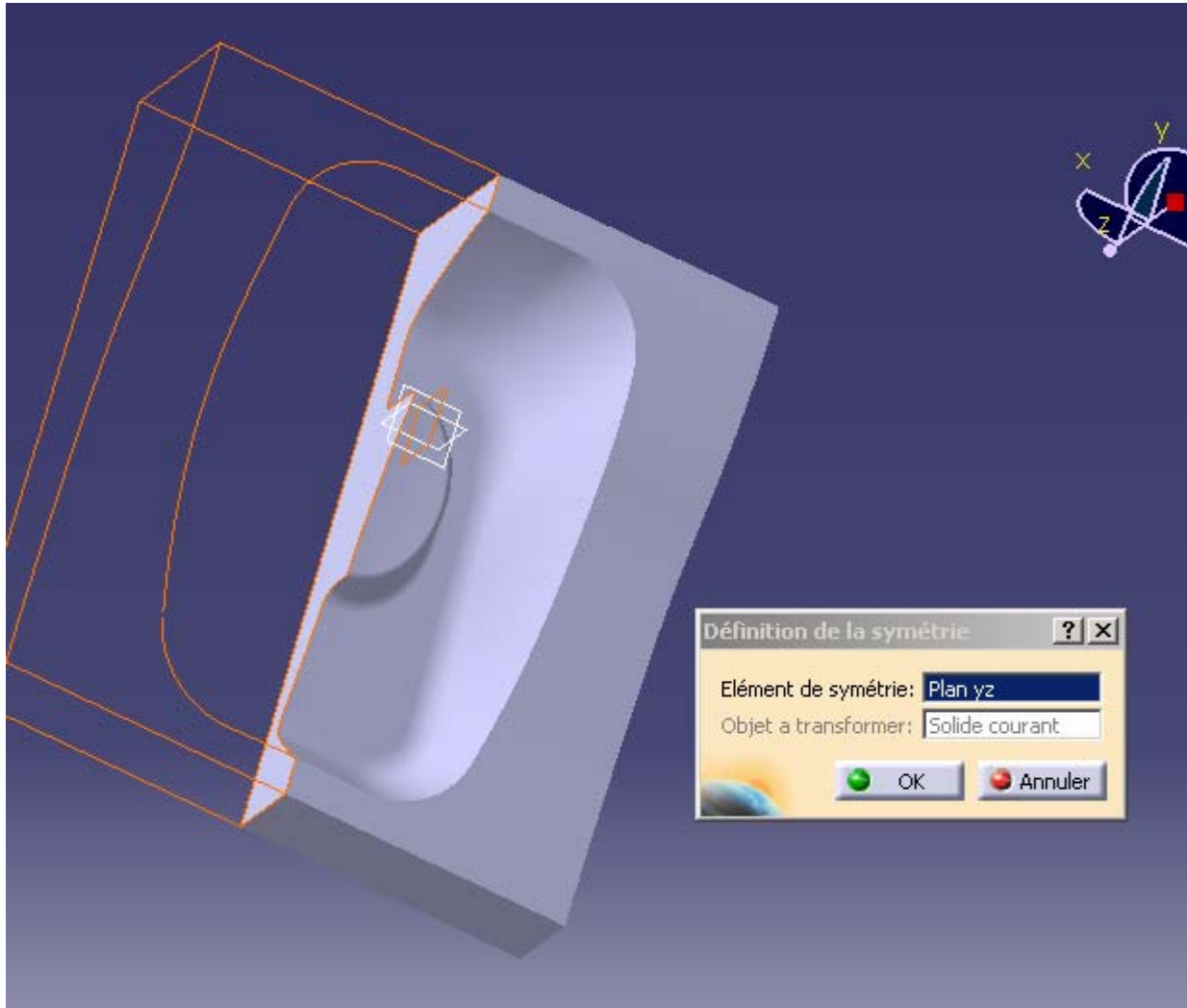

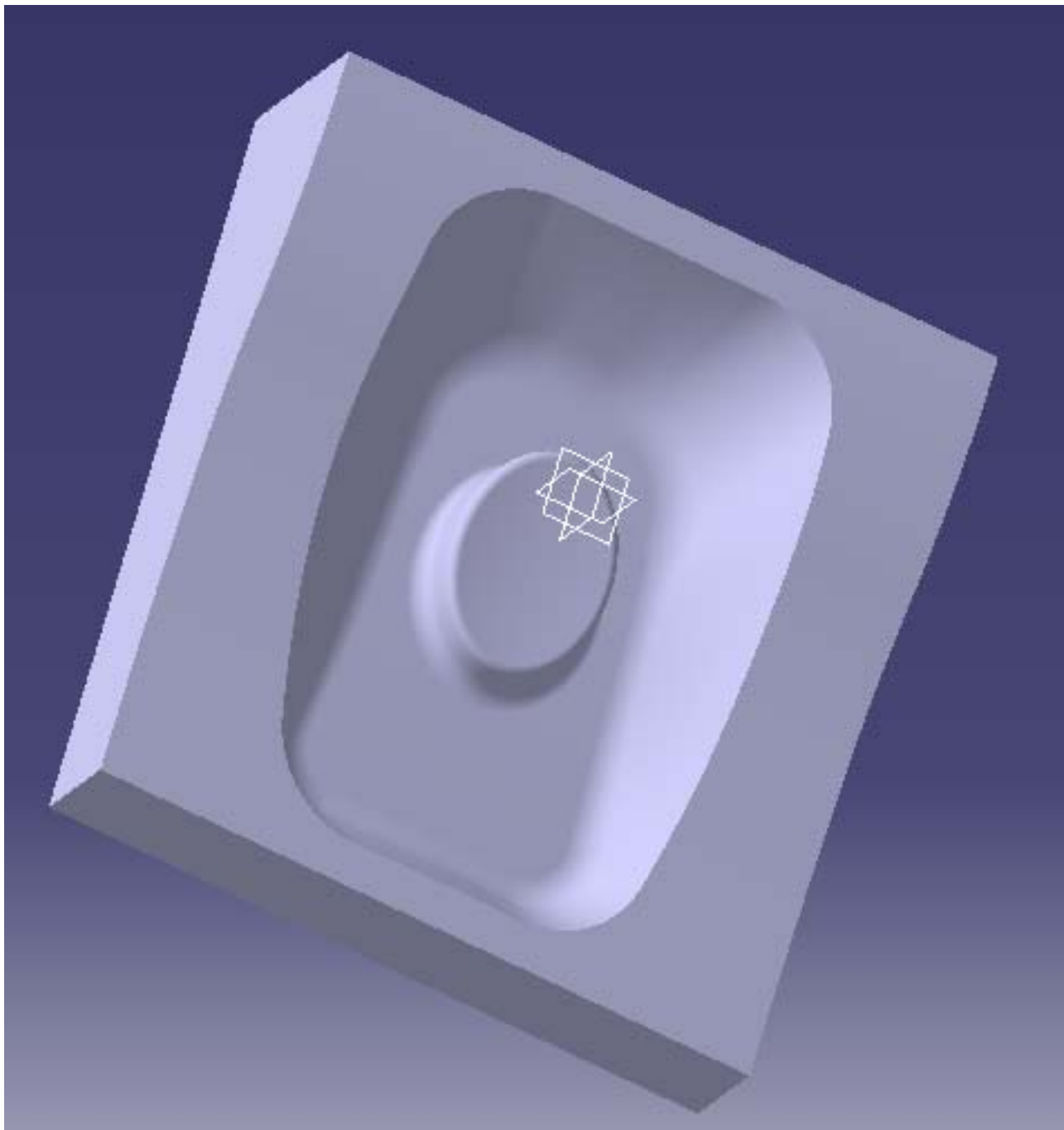

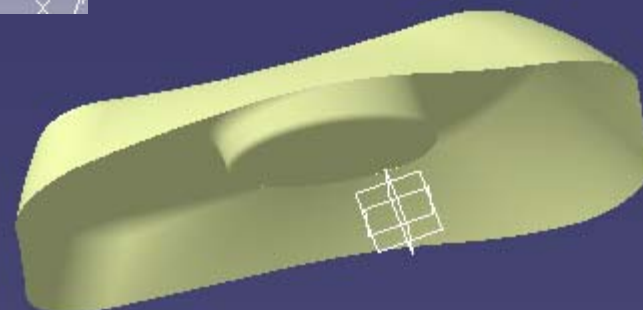
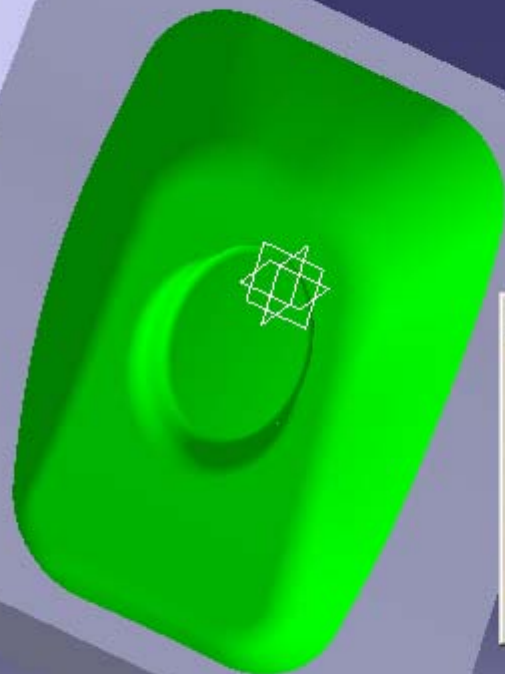

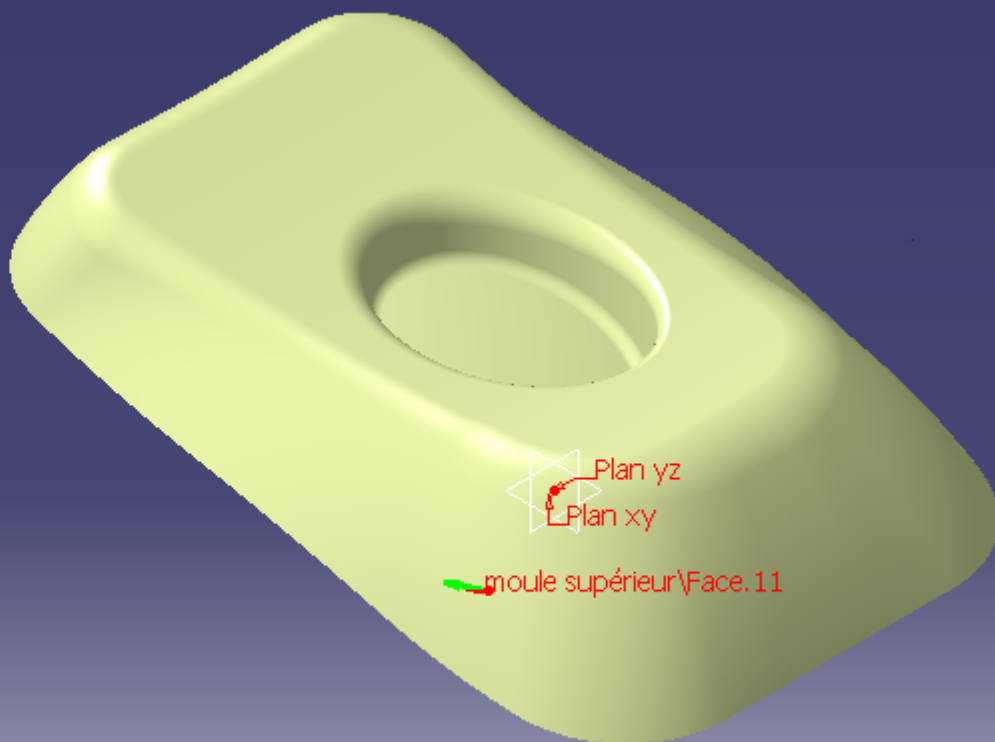
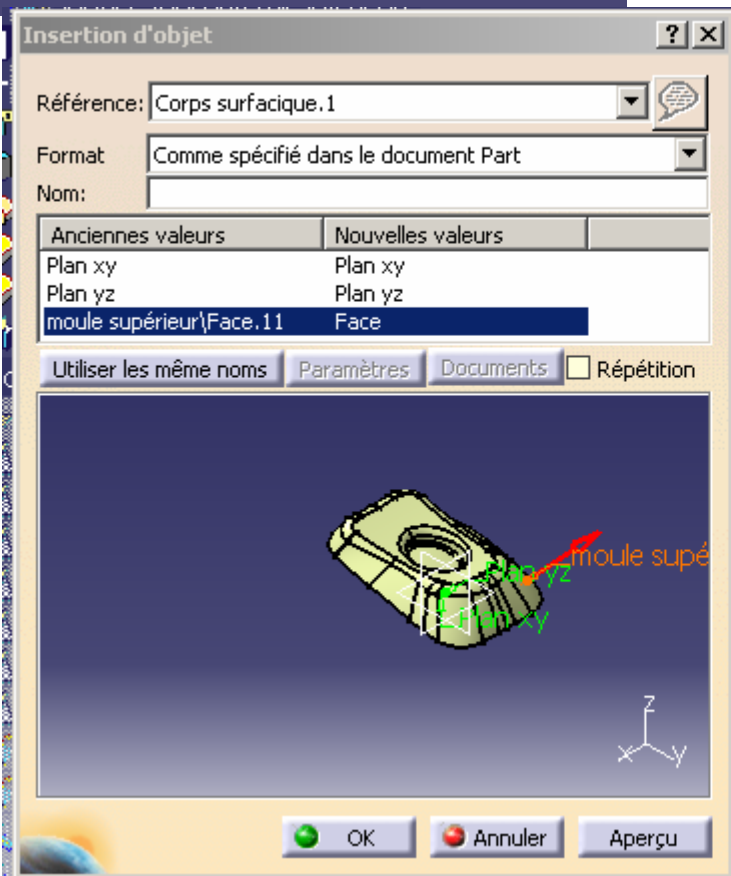
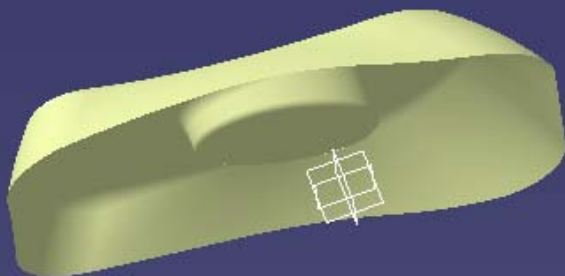

Composants issus ...

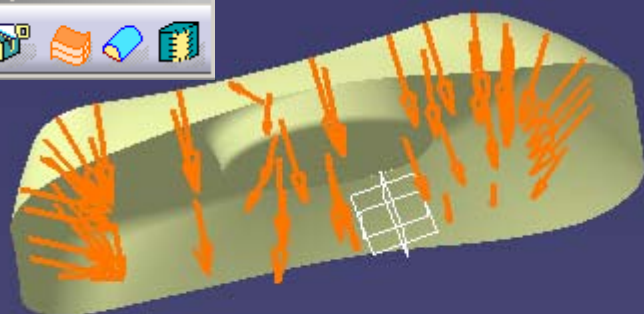

Surface Epaisse ? X

Première épaisseur: 2mm

Deuxième épaisseur: 0mm

Objet: Surface externe pièce

Inverse la direction

OK Annuler Aperçu

